



# Índice

<b>1</b>	<b>Tipologias .....</b>	<b>4</b>
<b>2</b>	<b>Diagramas de dimensões .....</b>	<b>7</b>
<b>3</b>	<b>Perfis .....</b>	<b>16</b>
<b>4</b>	<b>Componentes .....</b>	<b>32</b>
<b>5</b>	<b>Arquivos eletrônicos .....</b>	<b>42</b>

ALCOA

## Fachada Contínua

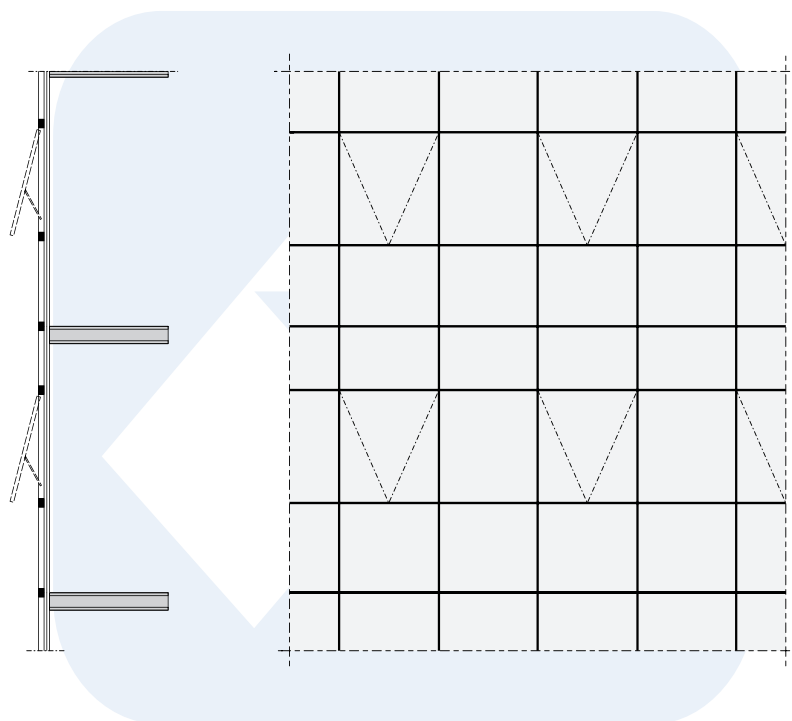

ALCOA



## Térreos

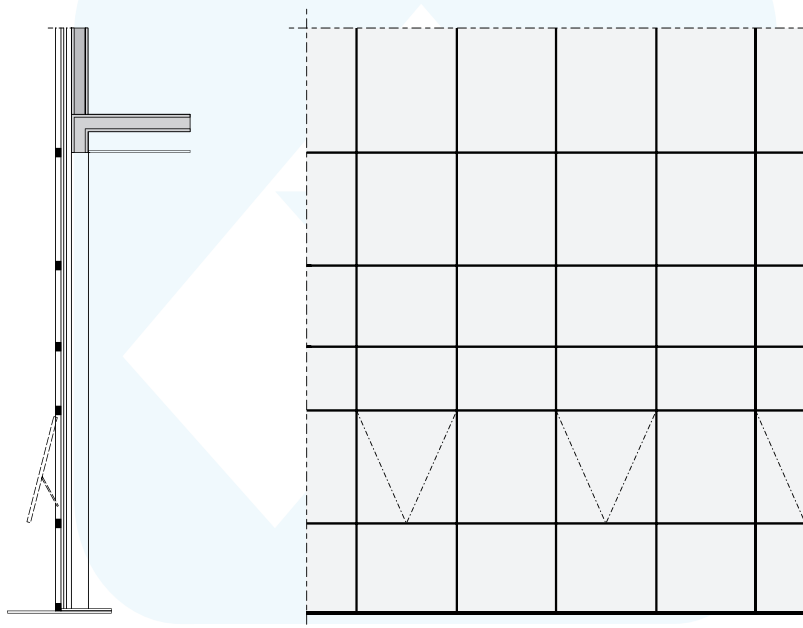

ALCOA

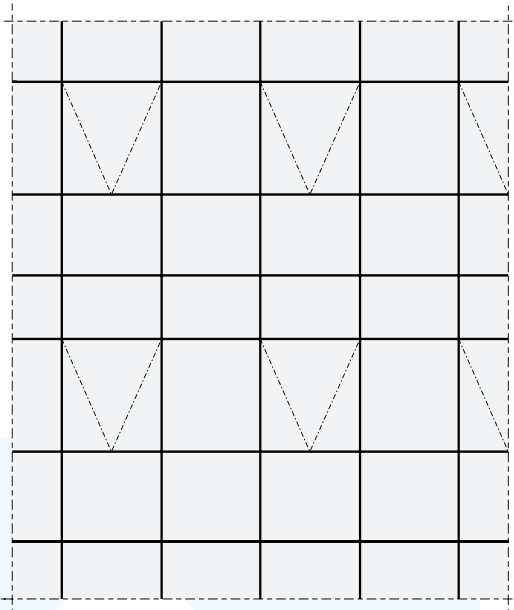
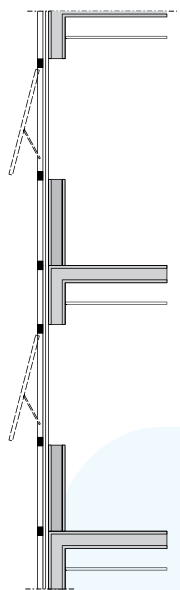

**Fachada Entre-vão**

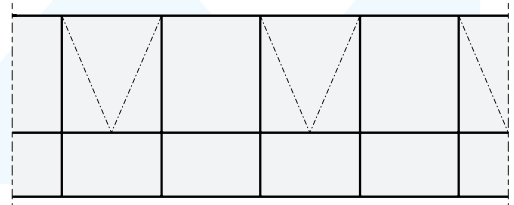
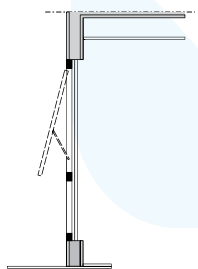

**Fachada Entre-vão**

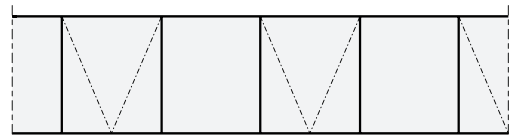
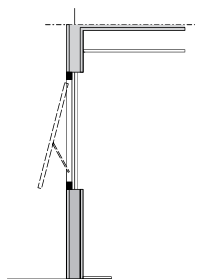



## Engaste / Apoio Simples

Liga 6060 T5

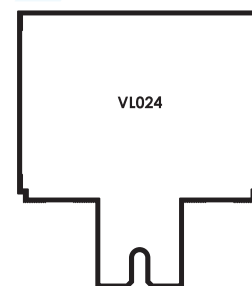
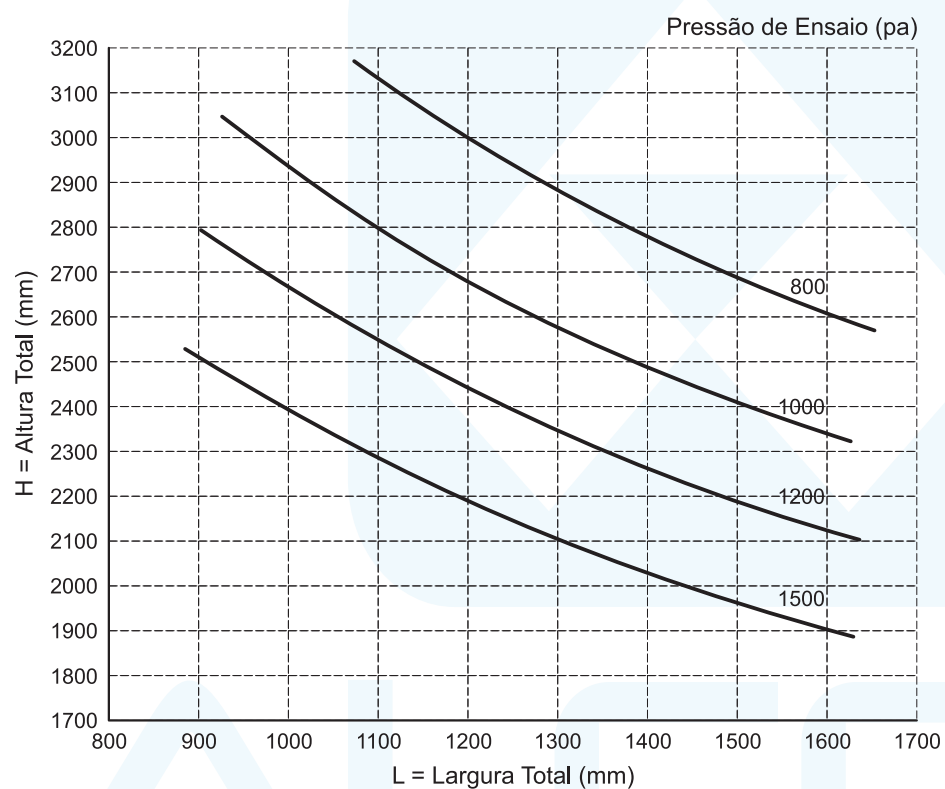
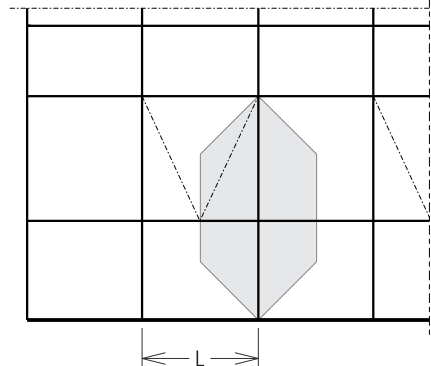
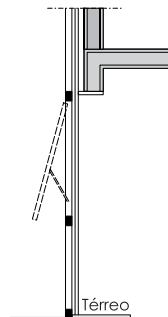

VL024  
Área = 657 mm<sup>2</sup>  
Jx = 733153 mm<sup>4</sup>  
Wx = 15338 mm<sup>3</sup>

## Engaste / Apoio Simples

Liga 6005A T5 (Sob consulta)

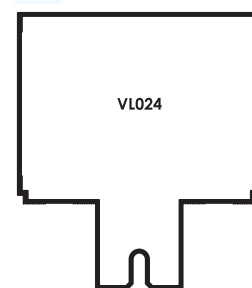
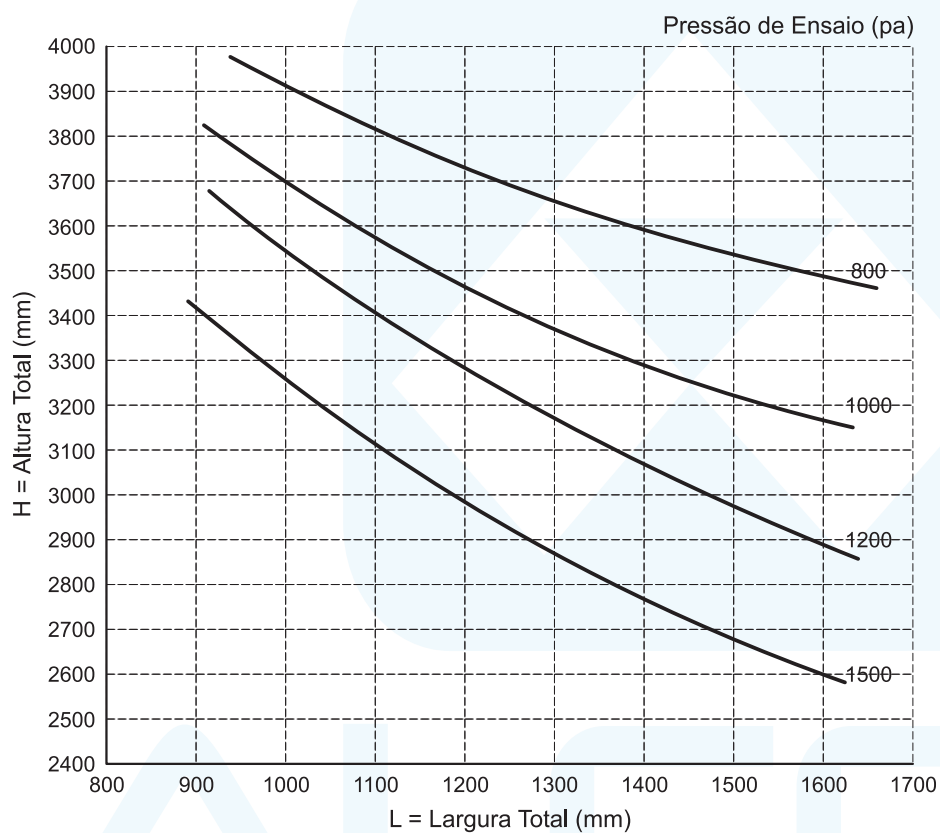
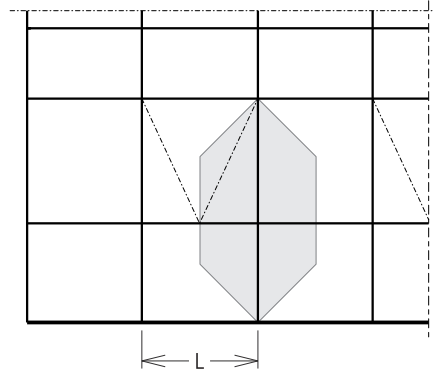
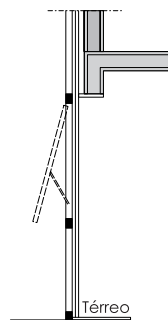

VL024  
Área = 657 mm<sup>2</sup>  
Jx = 733153 mm<sup>4</sup>  
Wx = 15338 mm<sup>3</sup>



## Cálculo Envelope

### VL024 : Liga 6060 - Têmpera T5

#### Pressões máximas

Vão entre colunas = 1000 mm: pressão máxima = 90 kg/m<sup>2</sup>

Vão entre colunas = 1250 mm: pressão máxima = 72 kg/m<sup>2</sup>

#### Esforços nas Ancoragens

Vão = 1000 mm: Pv = 124 kg      Ph = 280 kg

Vão = 1250 mm: Pv = 155 kg      Ph = 280 kg

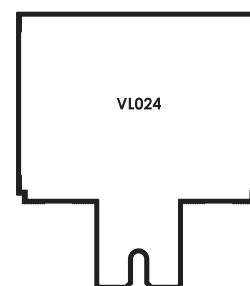
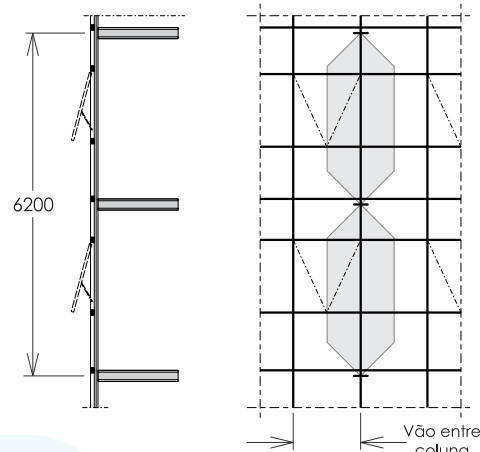

Área = 657 mm<sup>2</sup>  
Jx = 733153 mm<sup>4</sup>  
Wx = 15338 mm<sup>3</sup>

### VL024 : Liga 6005A - Têmpera T5 (Sob consulta)

#### Pressões máximas

Vão entre colunas = 1000 mm: pressão máxima = 166 kg/m<sup>2</sup>

Vão entre colunas = 1250 mm: pressão máxima = 133 kg/m<sup>2</sup>

#### Esforços nas Ancoragens

Vão = 1000 mm: Pv = 124 kg      Ph = 515 kg

Vão = 1250 mm: Pv = 155 kg      Ph = 515 kg

## Cálculo Envelope

### VL024 : Liga 6060 - Têmpera T5

#### Pressões máximas

Vão entre colunas = 1000 mm: pressão máxima = 129 kg/m<sup>2</sup>

Vão entre colunas = 1250 mm: pressão máxima = 108 kg/m<sup>2</sup>

#### Esforços nas Ancoragens

Vão = 1000 mm: Pv = 114 kg      Ph = 368 kg

Vão = 1250 mm: Pv = 142 kg      Ph = 368 kg

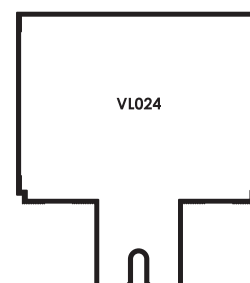
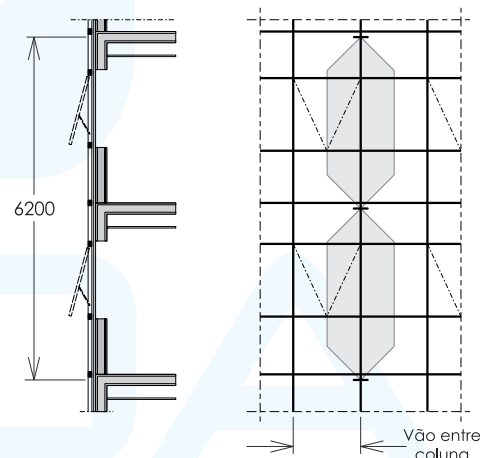

Área = 657 mm<sup>2</sup>  
Jx = 733153 mm<sup>4</sup>  
Wx = 15338 mm<sup>3</sup>

### VL024 : Liga 6005A - Têmpera T5 (Sob consulta)

#### Pressões máximas

Vão entre colunas = 1000 mm: pressão máxima = 183 kg/m<sup>2</sup>

Vão entre colunas = 1250 mm: pressão máxima = 147 kg/m<sup>2</sup>

#### Esforços nas Ancoragens

Vão = 1000 mm: Pv = 124 kg      Ph = 521 kg

Vão = 1250 mm: Pv = 155 kg      Ph = 521 kg



## Cálculo Envelope

### VL025 : Liga 6060 - Têmpera T5

#### Pressões máximas

Vão entre colunas = 1000 mm: pressão máxima = 151 kg/m<sup>2</sup>

Vão entre colunas = 1250 mm: pressão máxima = 134 kg/m<sup>2</sup>

#### Esforços nas Ancoragens

Vão = 1000 mm: Pv = 45 kg      Ph = 234 kg

Vão = 1250 mm: Pv = 58 kg      Ph = 260 kg

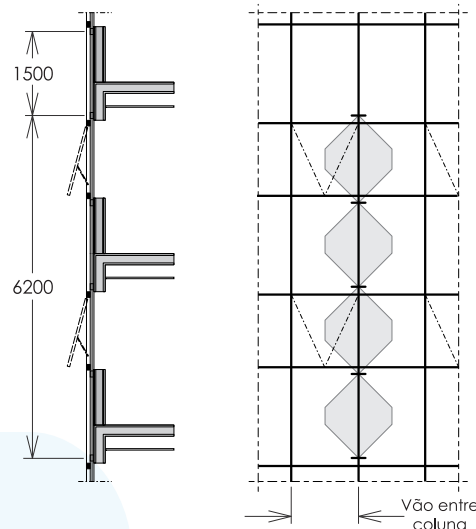

### VL025 : Liga 6005A - Têmpera T5 (Sob consulta)

#### Pressões máximas

Vão entre colunas = 1000 mm: pressão máxima = 228 kg/m<sup>2</sup>

Vão entre colunas = 1250 mm: pressão máxima = 196 kg/m<sup>2</sup>

#### Esforços nas Ancoragens

Vão = 1000 mm: Pv = 46 kg      Ph = 353 kg

Vão = 1250 mm: Pv = 58 kg      Ph = 380 kg

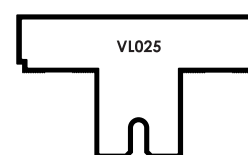

### VL001 : Liga 6005A - Têmpera T5 (Sob consulta)

#### Pressões máximas

Vão entre colunas = 1000 mm: pressão máxima = 81 kg/m<sup>2</sup>

#### Esforços nas Ancoragens

Vão = 1000 mm: Pv = 93 kg      Ph = 252 kg

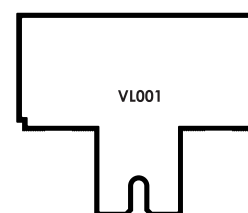
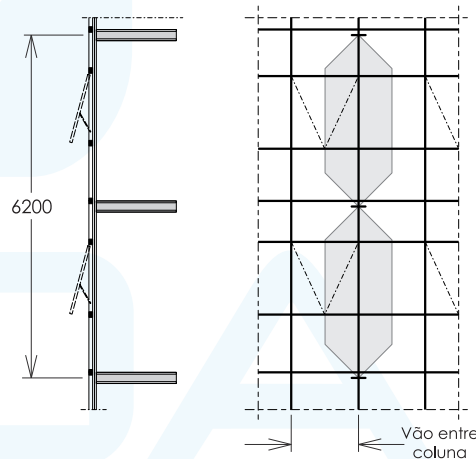

#### Nota

Sempre que houver possibilidade de se colocar mais de uma ancoragem, com espaçamento entre elas maior que 500mm, favor consultar, pois poderá favorecer do ponto de vista estrutural.

Área = 546 mm<sup>2</sup>  
Jx = 313839 mm<sup>4</sup>  
Wx = 8327 mm<sup>3</sup>



## Entre-vão

### VL026 : Liga 6060 - Têmpera T5

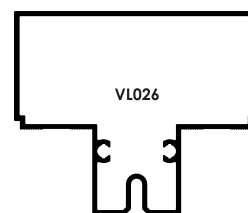
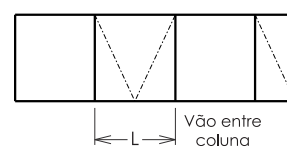
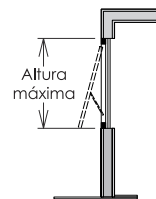
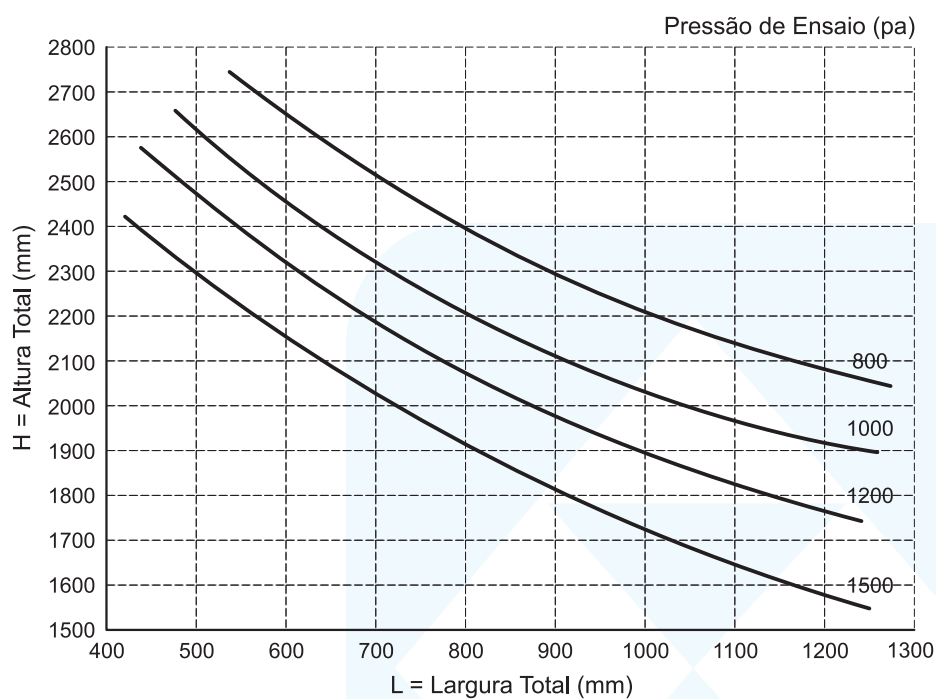

Área = 588 mm<sup>2</sup>  
Jx = 322871 mm<sup>4</sup>  
Wx = 8805 mm<sup>3</sup>

## Entre-vão

### VL027 : Liga 6060 - Têmpera T5

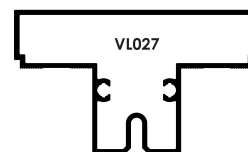
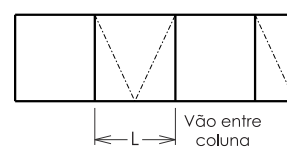
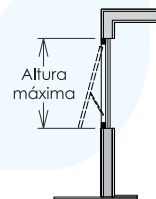
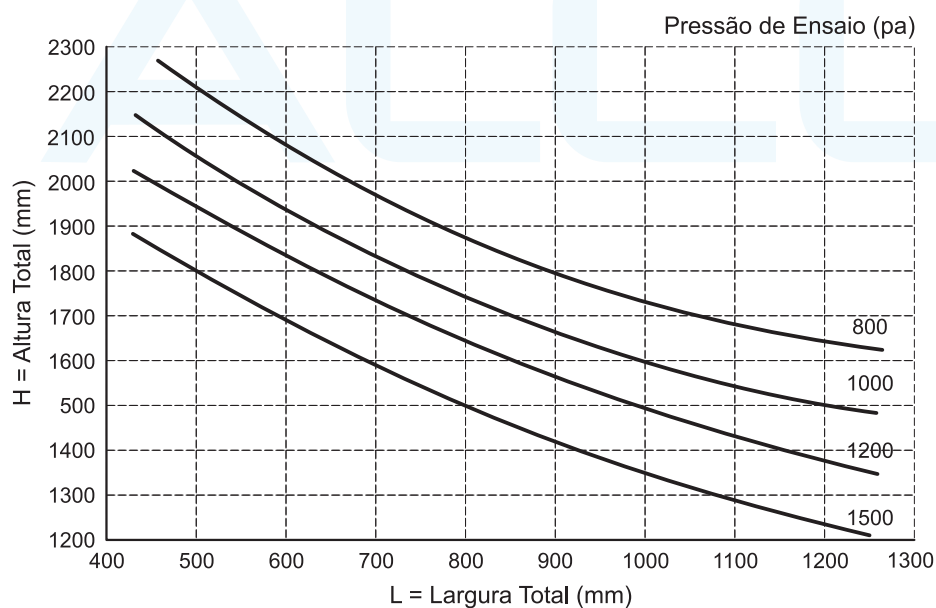

Área = 520 mm<sup>2</sup>  
Jx = 136635 mm<sup>4</sup>  
Wx = 4794 mm<sup>3</sup>

## Entre-vão

**VL004 : Liga 6060 - Têmpera T5**

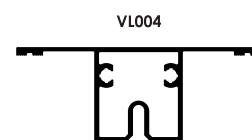
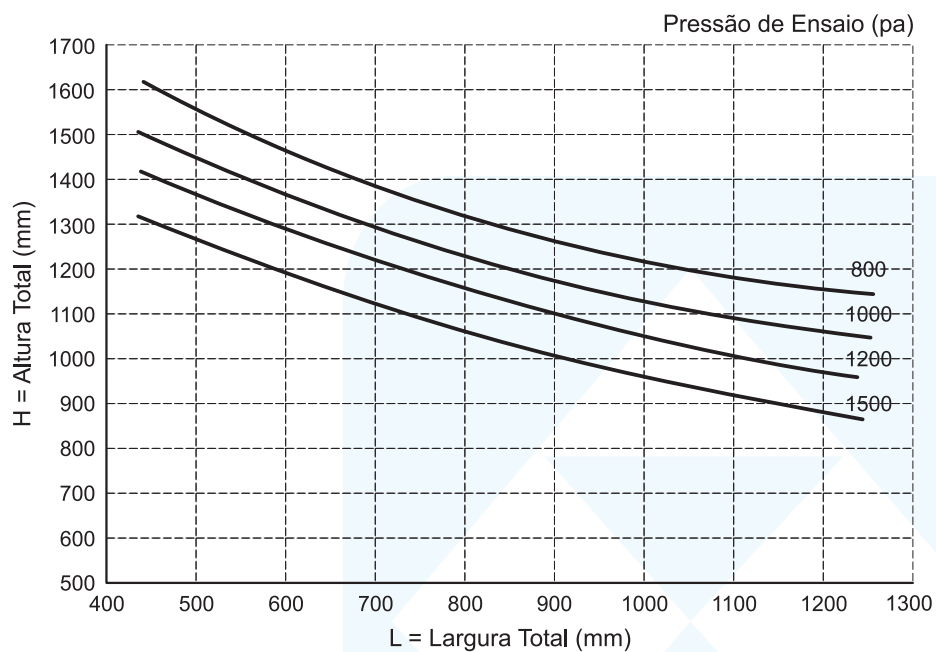
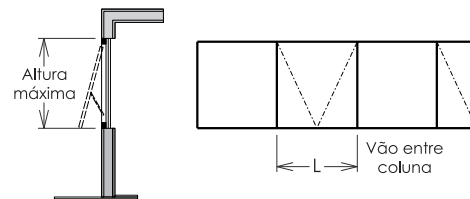

VL004  
Área = 366 mm<sup>2</sup>  
Jx = 47889 mm<sup>4</sup>  
Wx = 2412 mm<sup>3</sup>

## Duplo engaste

**VL001 : Liga 6060 - Têmpera T5**

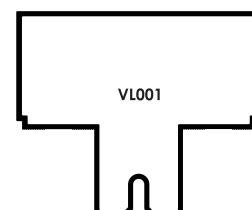
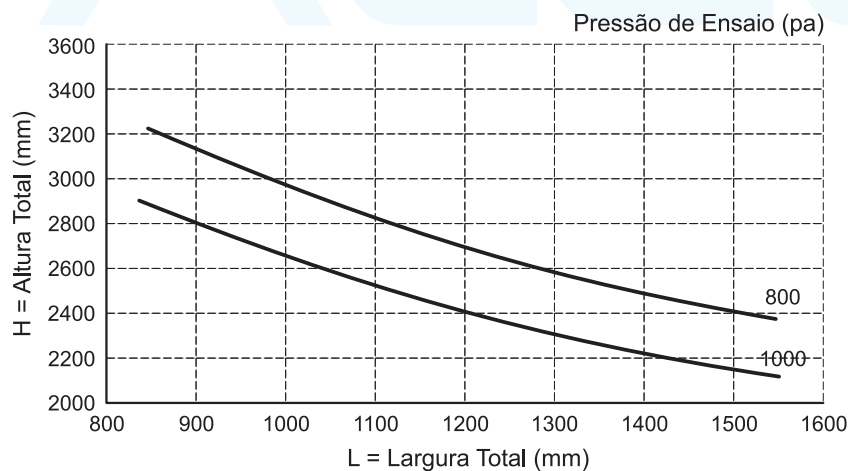
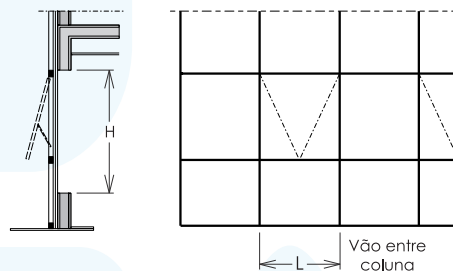

VL001  
Área = 546 mm<sup>2</sup>  
Jx = 313839 mm<sup>4</sup>  
Wx = 8327 mm<sup>3</sup>

## Engaste / Apoio simples

VL026 : Liga 6005 - Têmpera T5 (Sob consulta)

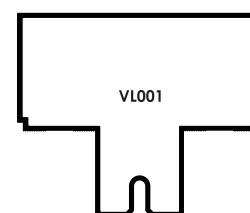
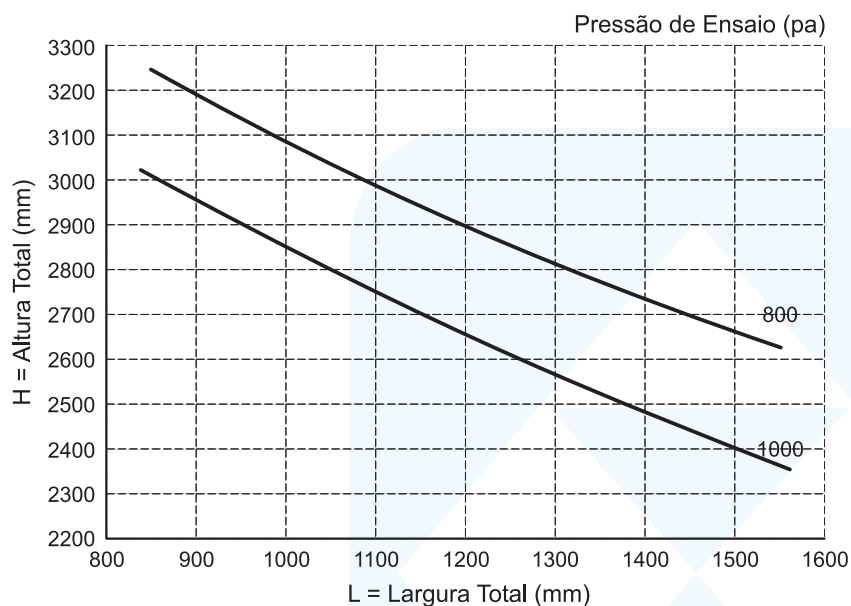
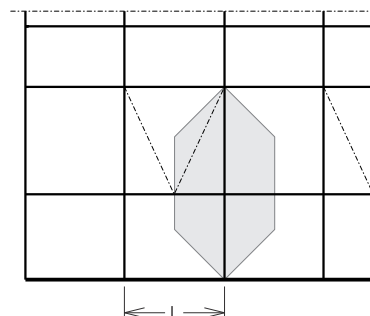
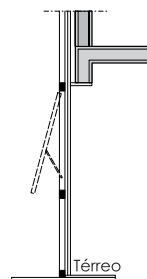

Área = 546 mm<sup>2</sup>  
Jx = 313839 mm<sup>4</sup>  
Wx = 8327 mm<sup>3</sup>

## Cálculo Envelope

VL001 : Liga 6060 - Têmpera T5

### Pressões máximas

Vão entre colunas = 1000 mm: pressão máxima = 269 kg/m<sup>2</sup>  
Vão entre colunas = 1250 mm: pressão máxima = 204 kg/m<sup>2</sup>

### Esforços nas Ancoragens

Vão = 1000 mm: Pv = 62 kg      Ph = 417 kg  
Vão = 1250 mm: Pv = 78 kg      Ph = 395 kg

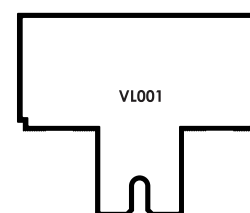
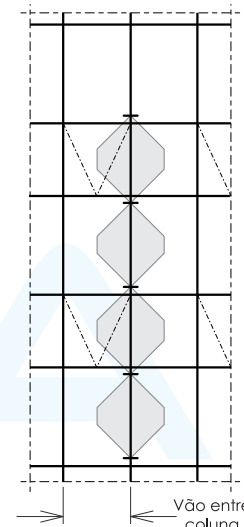
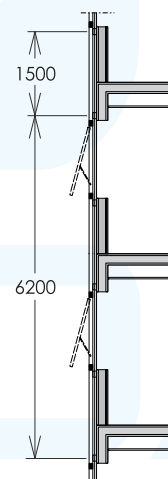

Área = 546 mm<sup>2</sup>  
Jx = 313839 mm<sup>4</sup>  
Wx = 8327 mm<sup>3</sup>

## Engaste / Apoio simples

VL062 : Liga 6060 - Têmpera T5

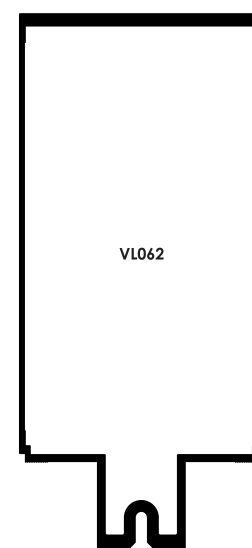
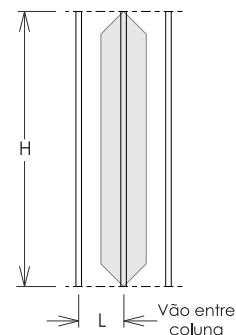
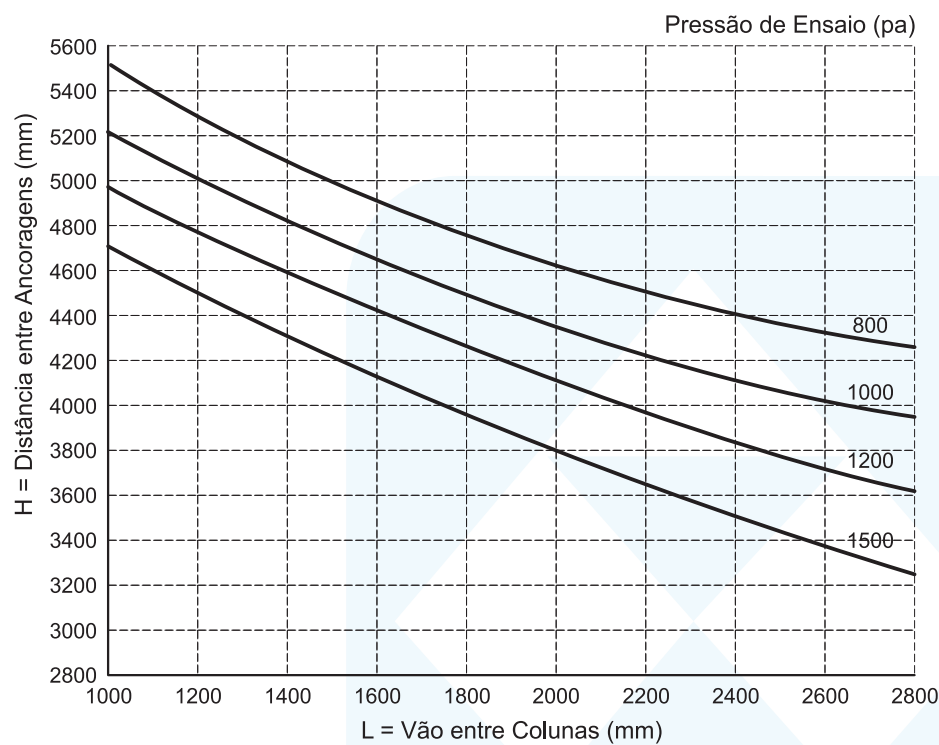

Área = 1474 mm<sup>2</sup>  
Jx = 6849010 mm<sup>4</sup>  
Wx = 77434 mm<sup>3</sup>

## Cálculo Envelope

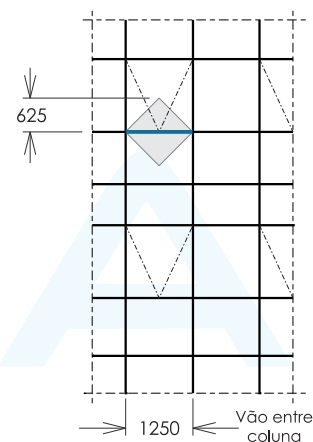
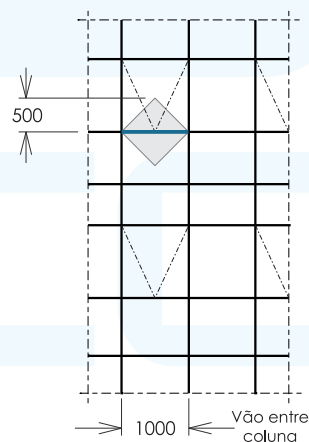

VL001 : Liga 6005A - Têmpera T5 (Sob consulta)

### Pressões máximas

Vão entre colunas = 1000 mm: pressão máxima = 470 kg/m<sup>2</sup>

Vão entre colunas = 1250 mm: pressão máxima = 240 kg/m<sup>2</sup>

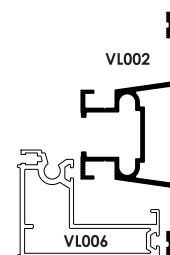

Área = 639 mm<sup>2</sup>  
Jx = 178134 mm<sup>4</sup>  
Wx = 5612 mm<sup>3</sup>



## Pressões máximas coluna LC048 / VL025

LC048/ LC049 / VL025 Bi-engastada : Liga 6065 - Têmpera T5

### Nota

Para os casos onde H é maior que 6 metros, sugerimos uma análise particular do caso, pois a partir desta medida teremos outras considerções, tais como:

1. Novos cálculos para quantidade de calços;
2. Previsão de melhor local para emenda do conjunto, caso seja necessário;
3. Fabricação / transporte / acabamento de superfície.

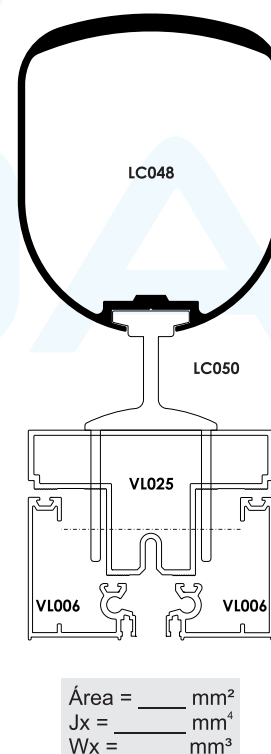
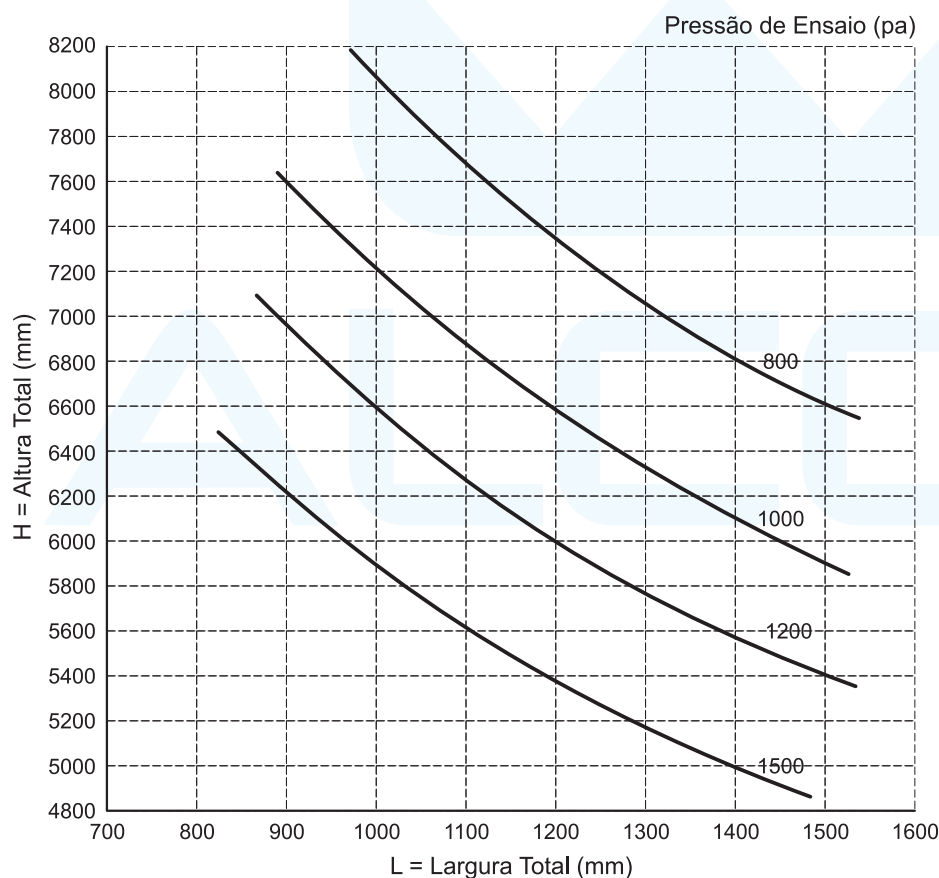
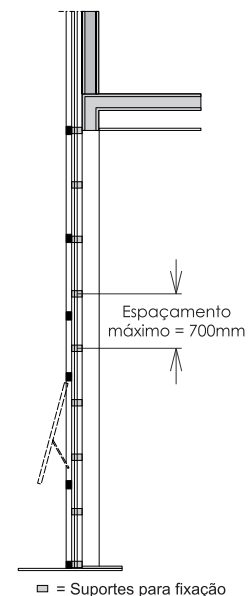



Código	Página
CL009	29
CL010	29
FC301	28
FC368	30
FC369	30
LC015	30
LC029	30
LC036	30
LC038	30
LC041	30
LC044	31
LC045	31
LC048	23
VL001	18
VL002	25
VL003	27
VL004	17
VL005	27
VL006	27
VL007	17
VL008	28
VL018	29
VL020	21
VL021	25
VL023	21
VL024	21
VL025	17
VL026	19
VL027	17
VL028	21
VL029	22
VL030	18
VL031	18

Código	Página
VL032	17
VL033	22
VL034	22
VL035	19
VL036	19
VL037	18
VL038	18
VL039	30
VL040	30
VL041	20
VL042	20
VL046	29
VL050	27
VL051	27
VL052	27
VL053	27
VL054	28
VL055	29
VL056	17
VL057	22
VL058	29
VL059	28
VL060	23
VL061	26
VL062	24
VL063	28
VL066	28
VL067	28
VL068	26
VL070	26
VL071	26
VL073	25

ALCOA

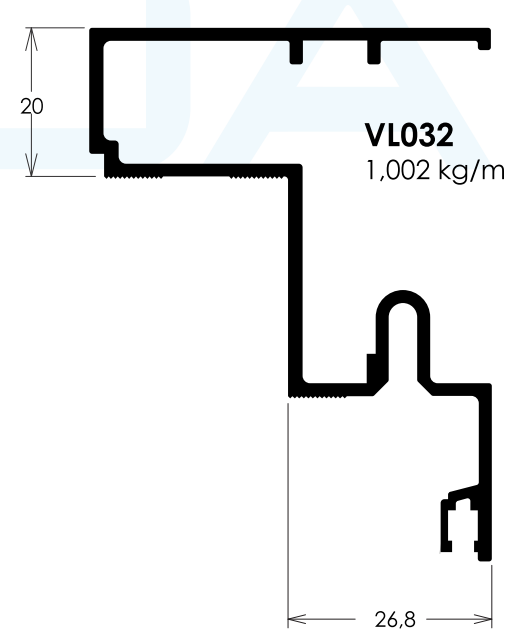
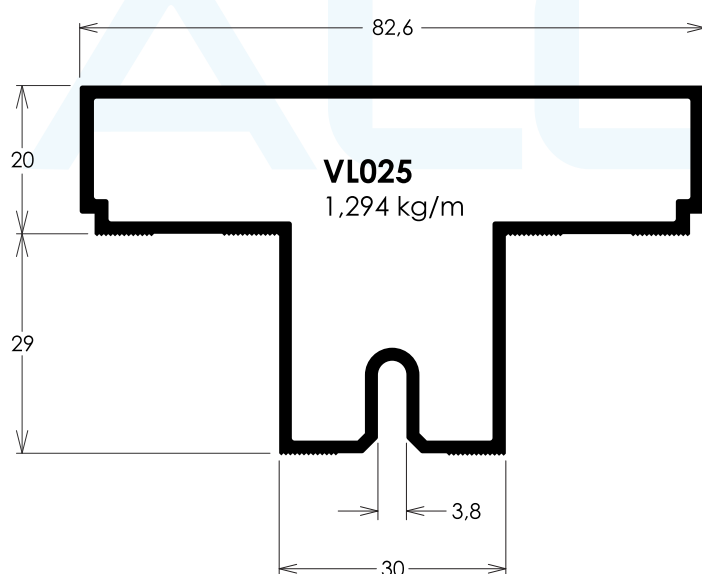
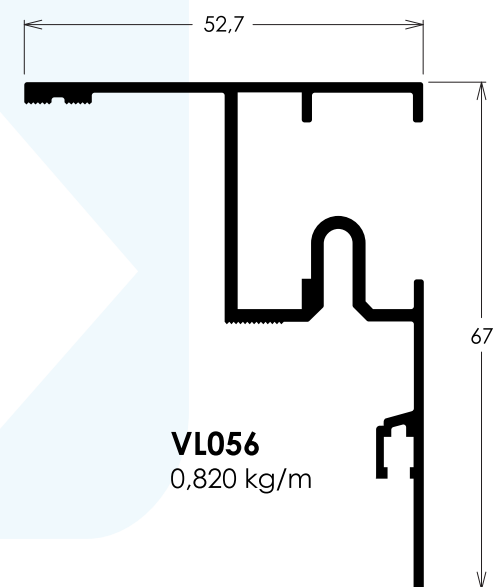
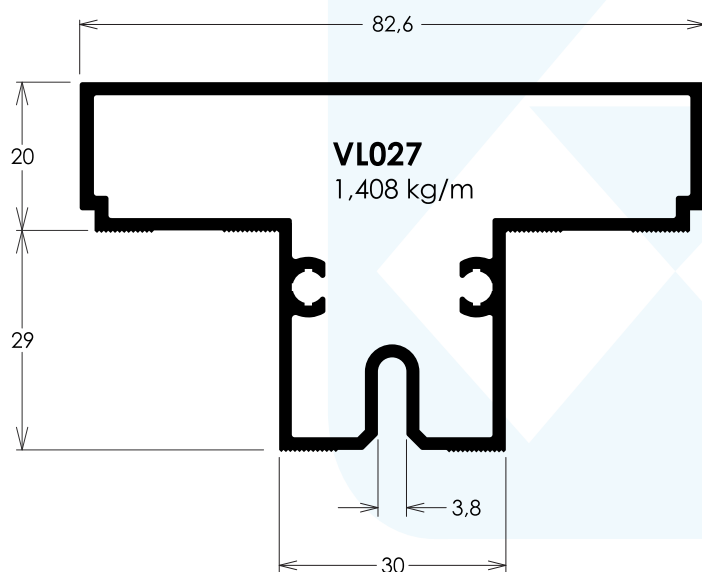
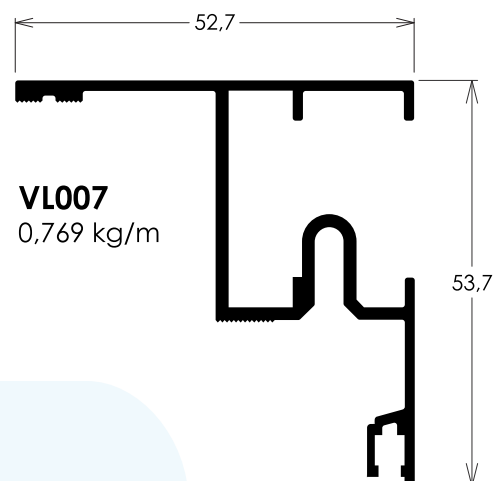
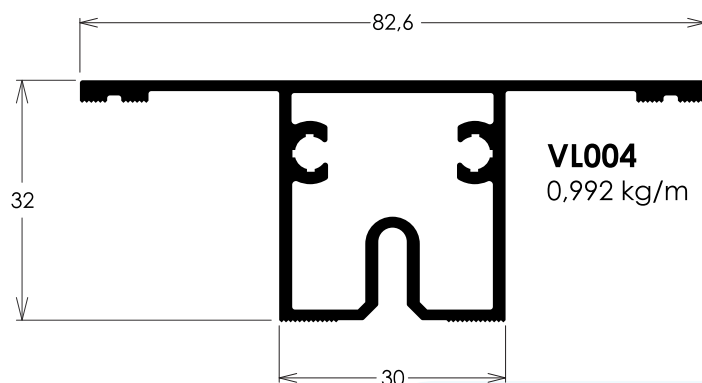

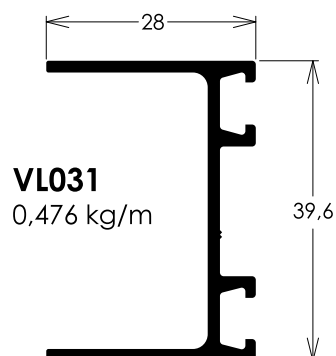
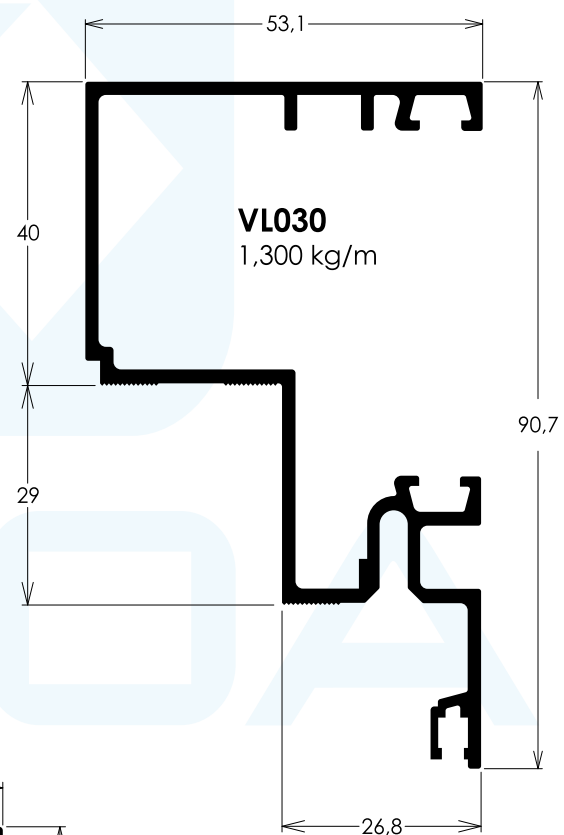
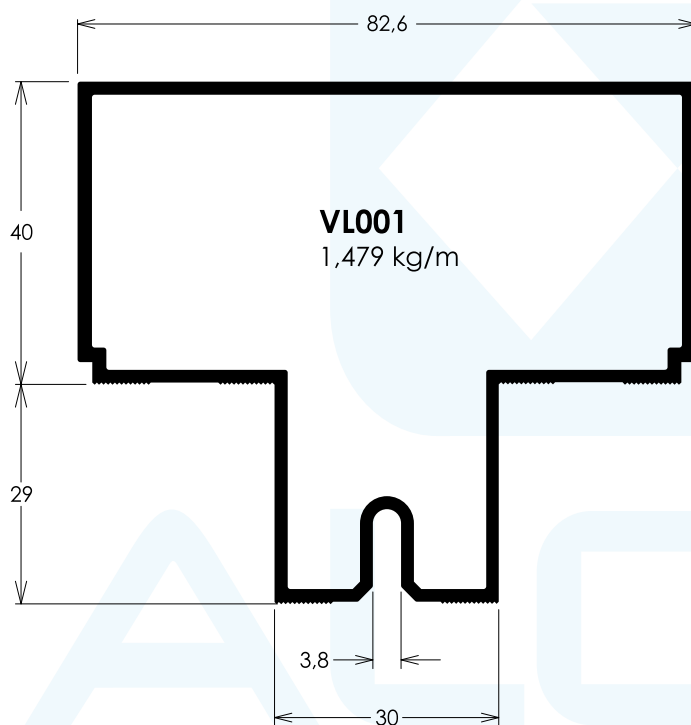
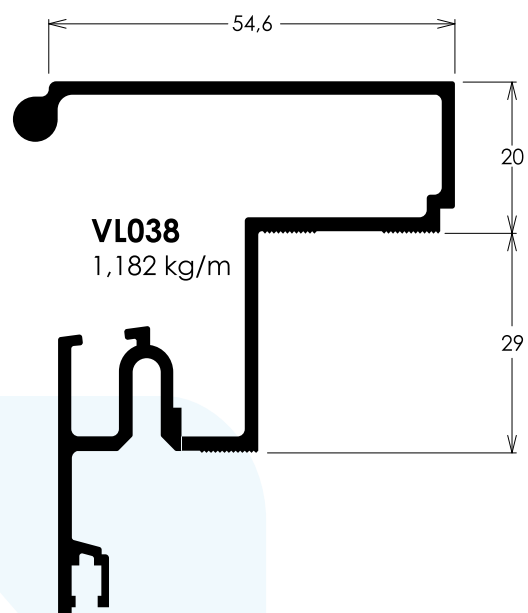
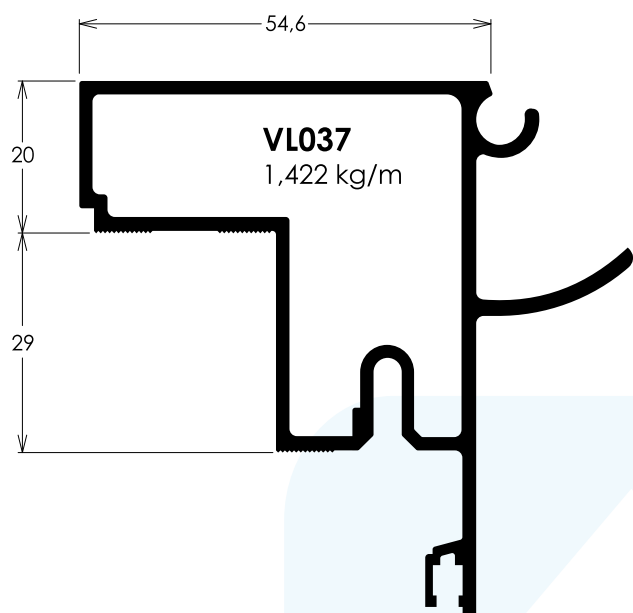



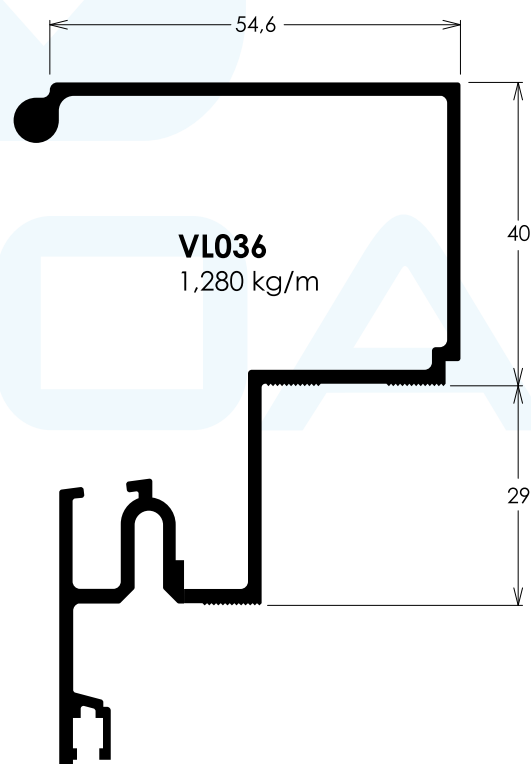
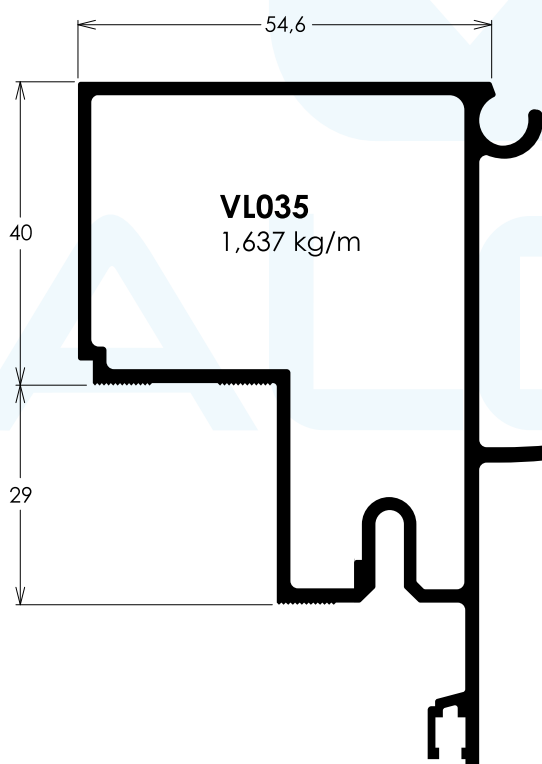
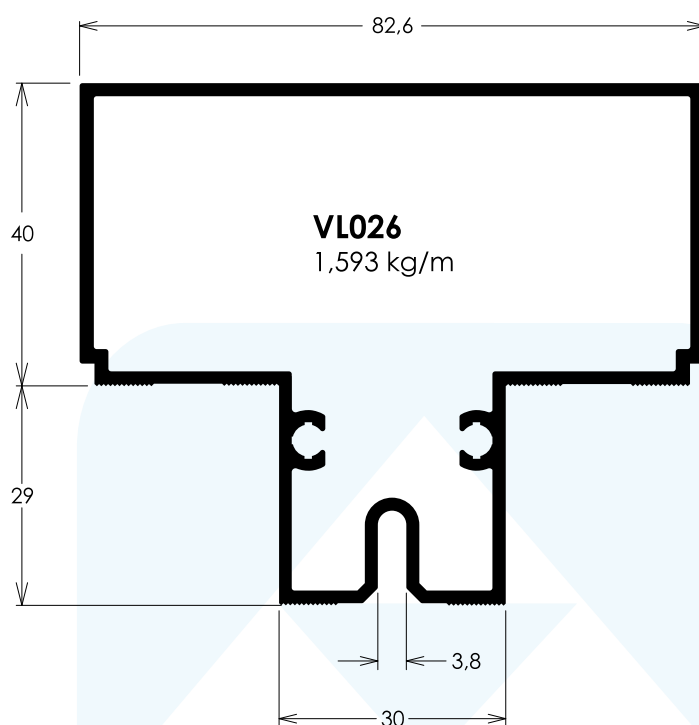

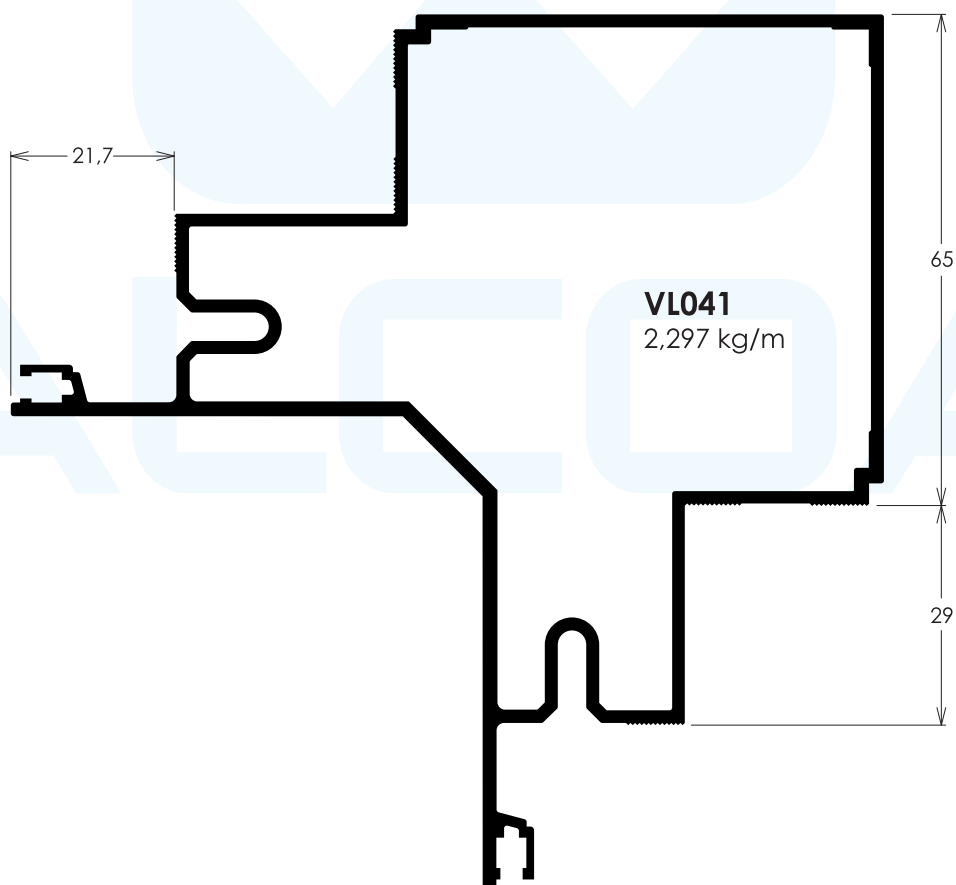
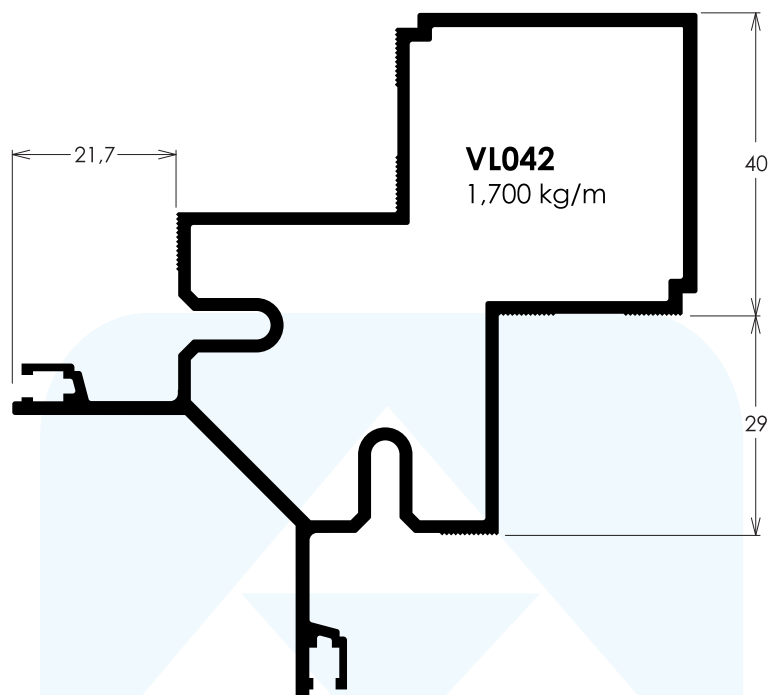

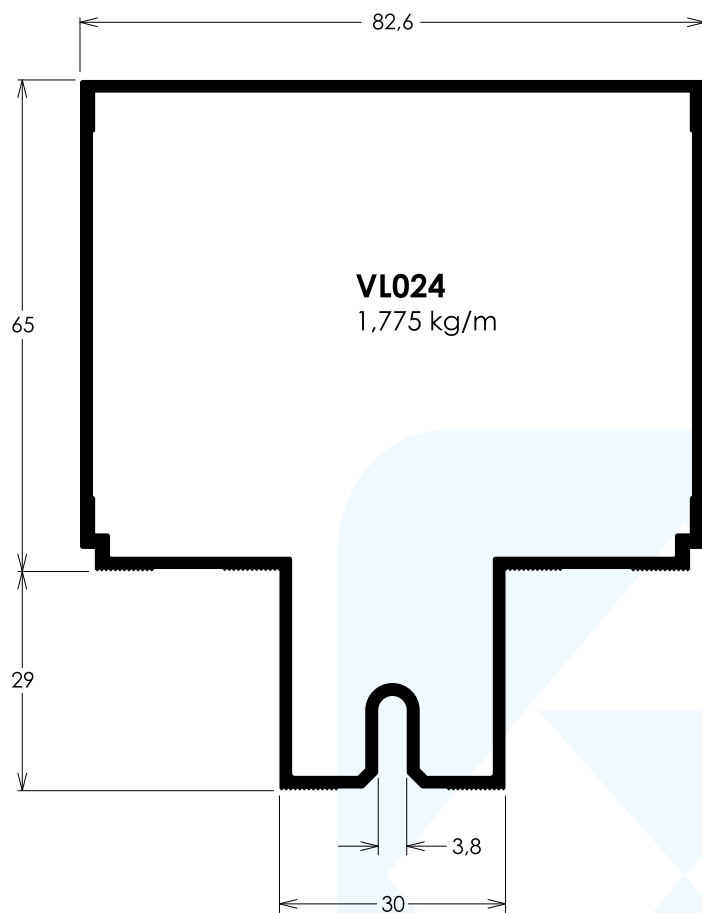

**VL024**  
1,775 kg/m

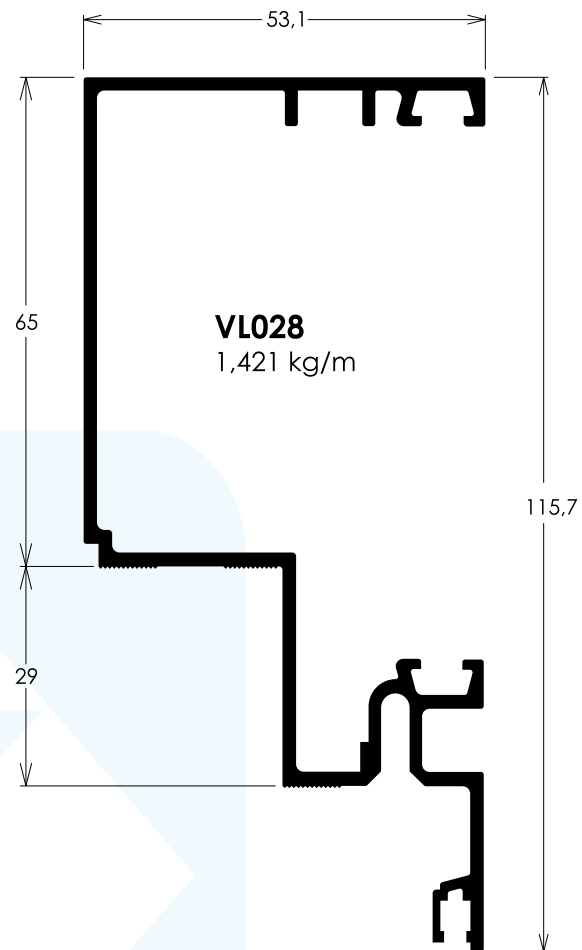

**VL028**  
1,421 kg/m

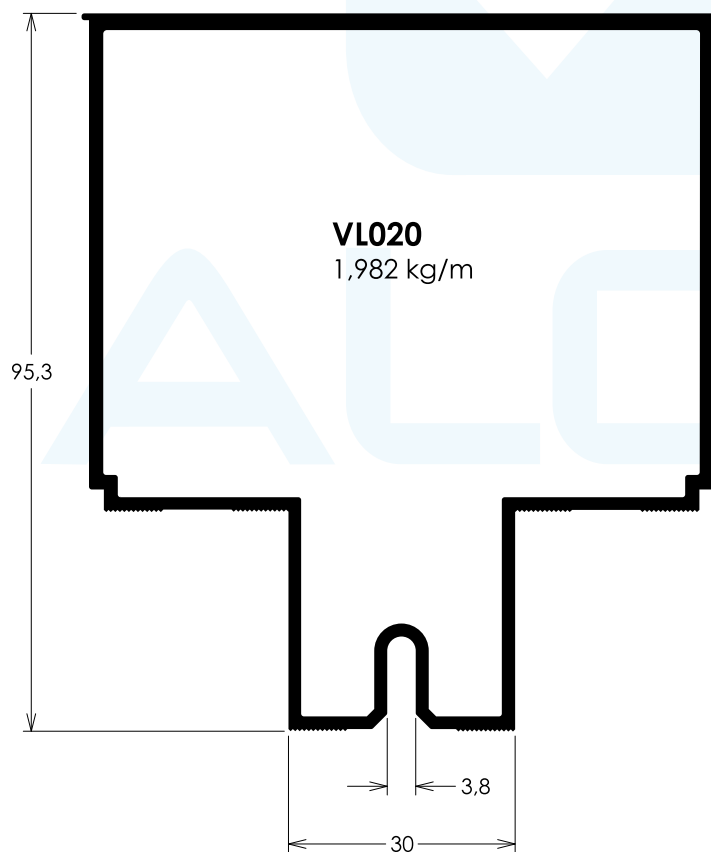

**VL020**  
1,982 kg/m

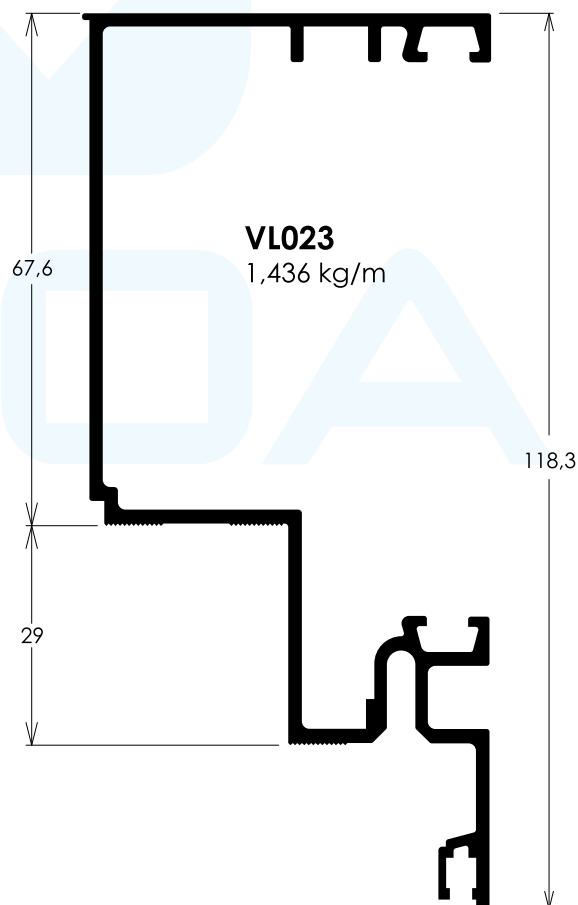

**VL023**  
1,436 kg/m

Projetos, perfis, componentes, códigos e sistemas estão sujeitos a alteração sem prévio aviso.

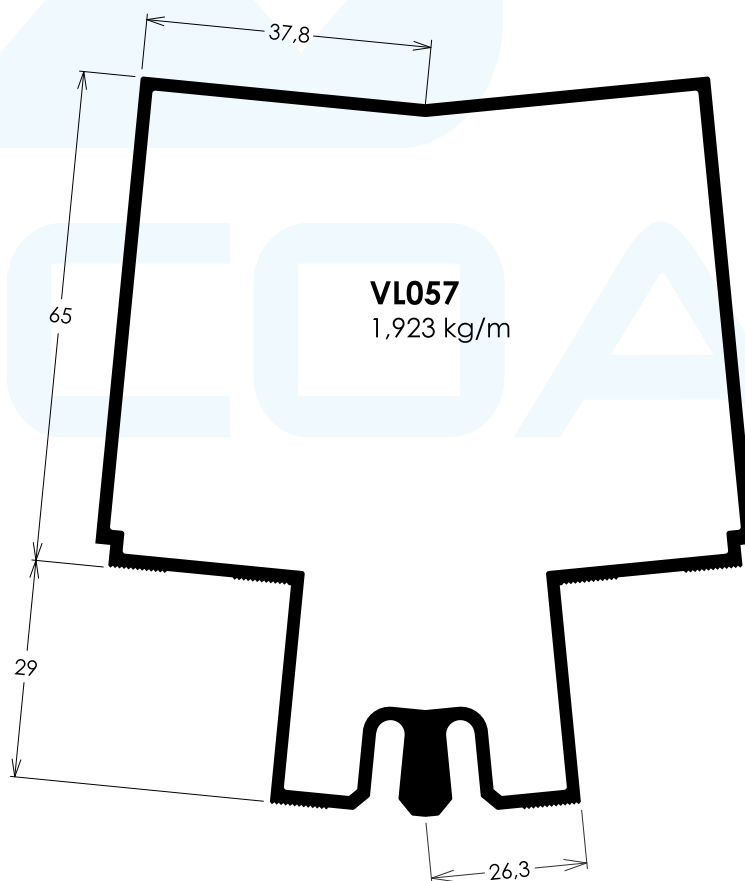
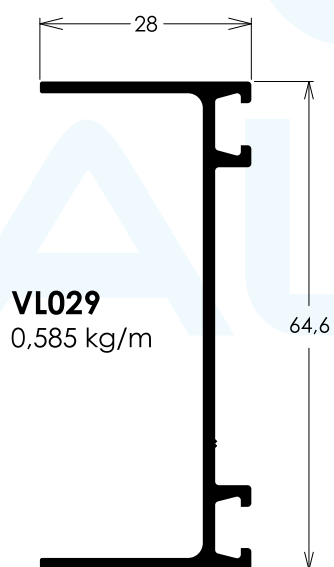
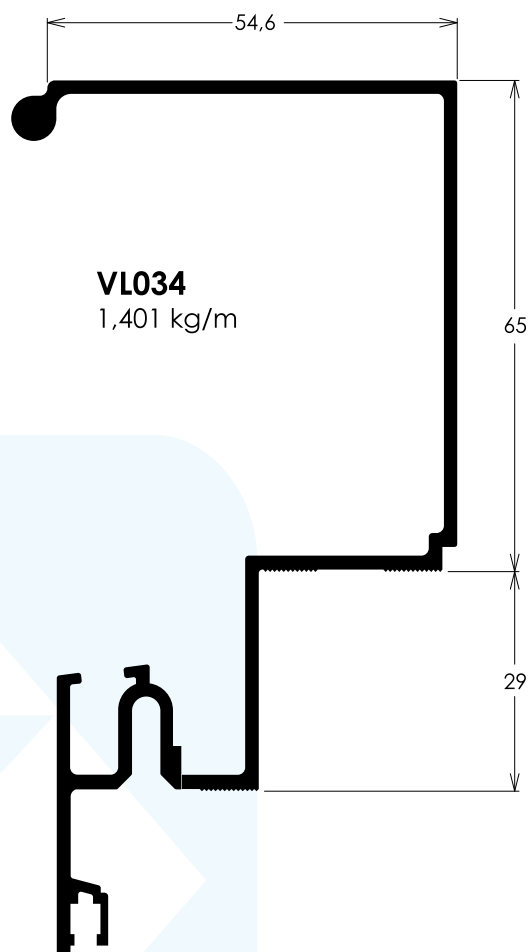
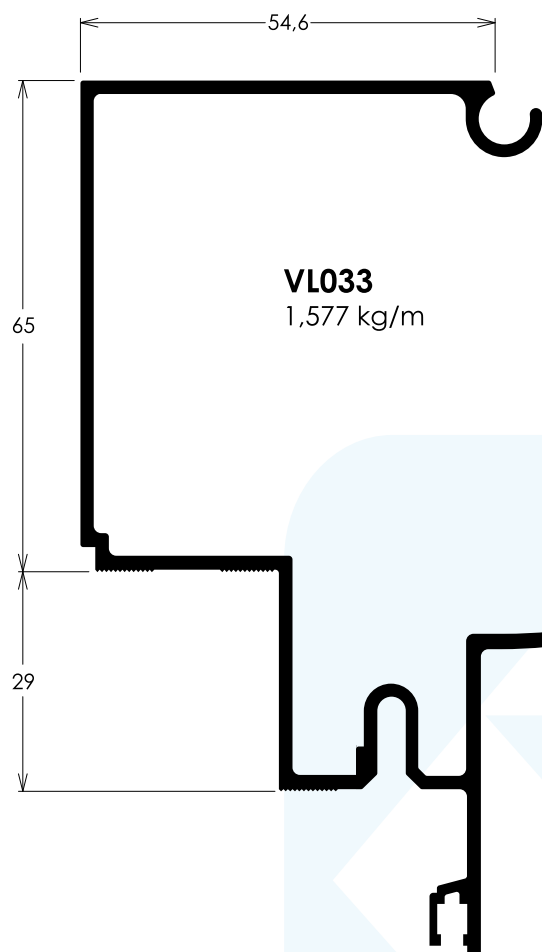

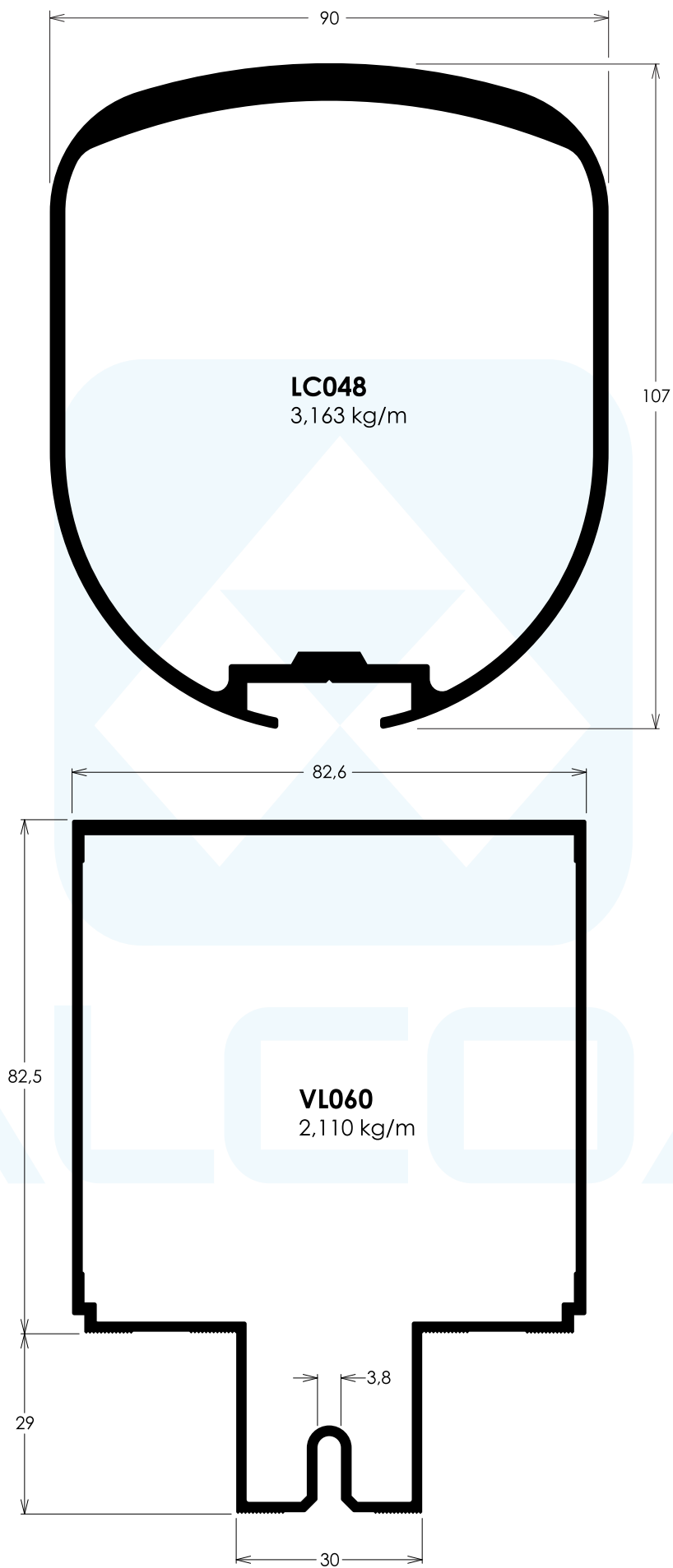

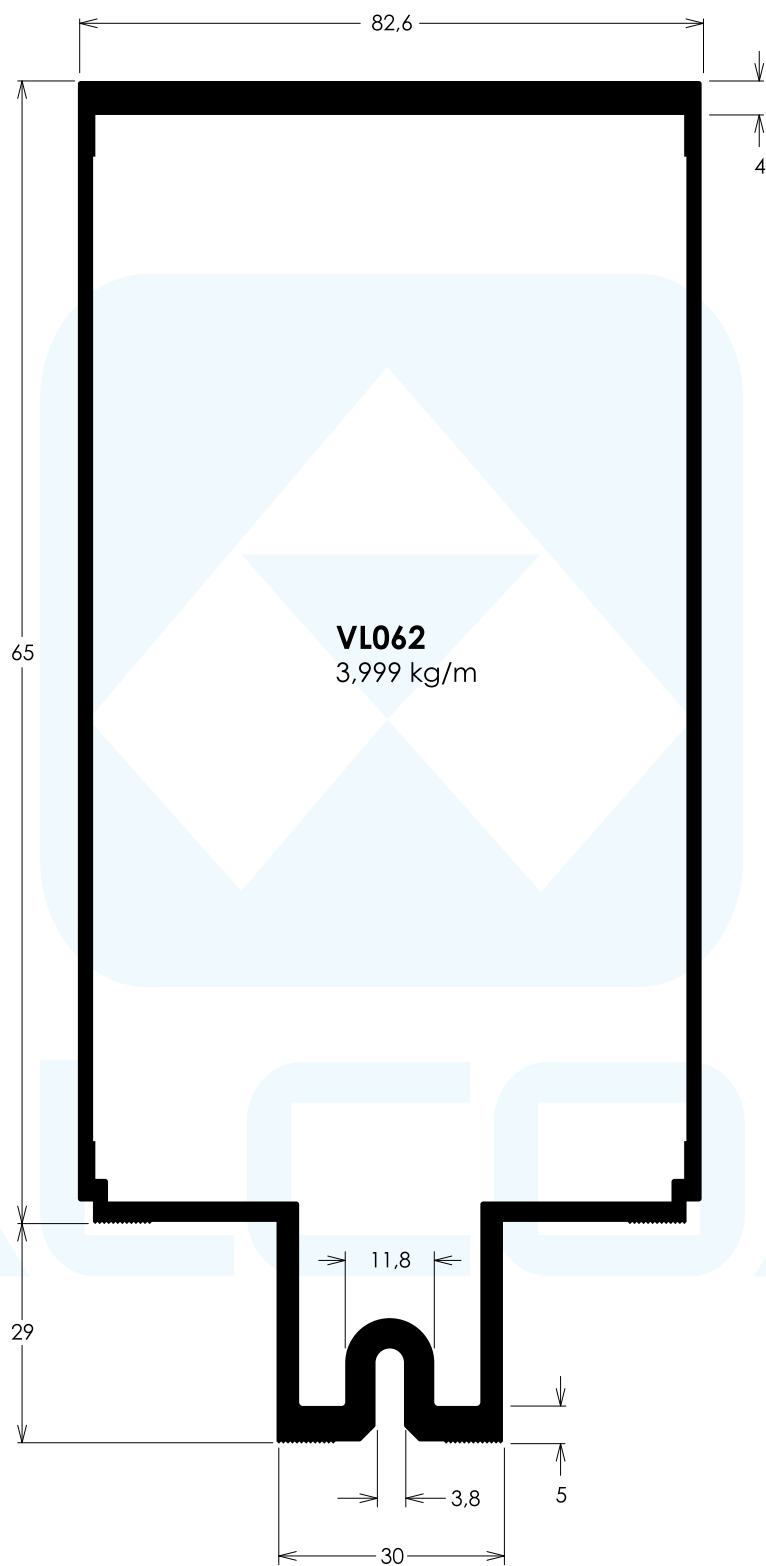

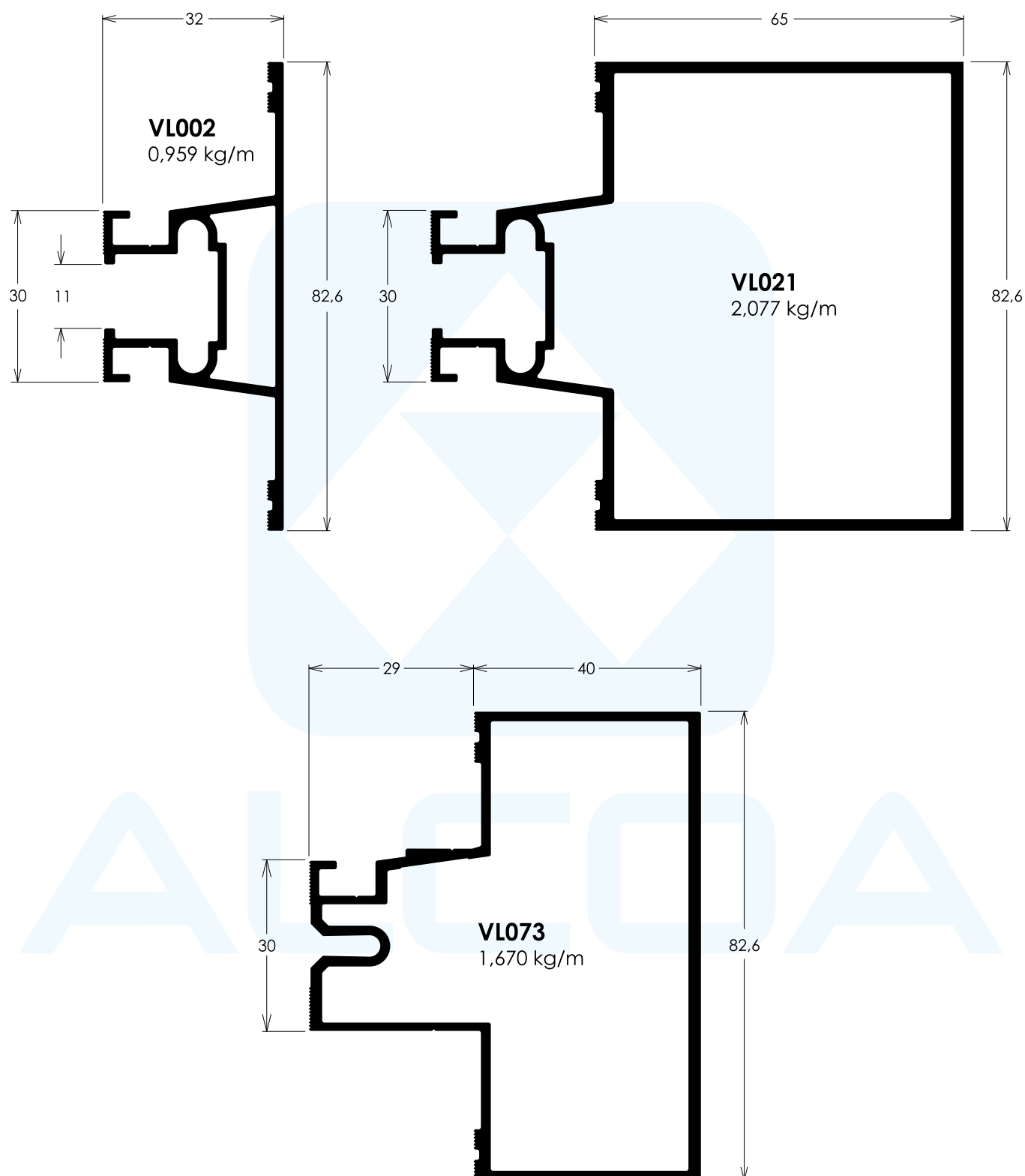

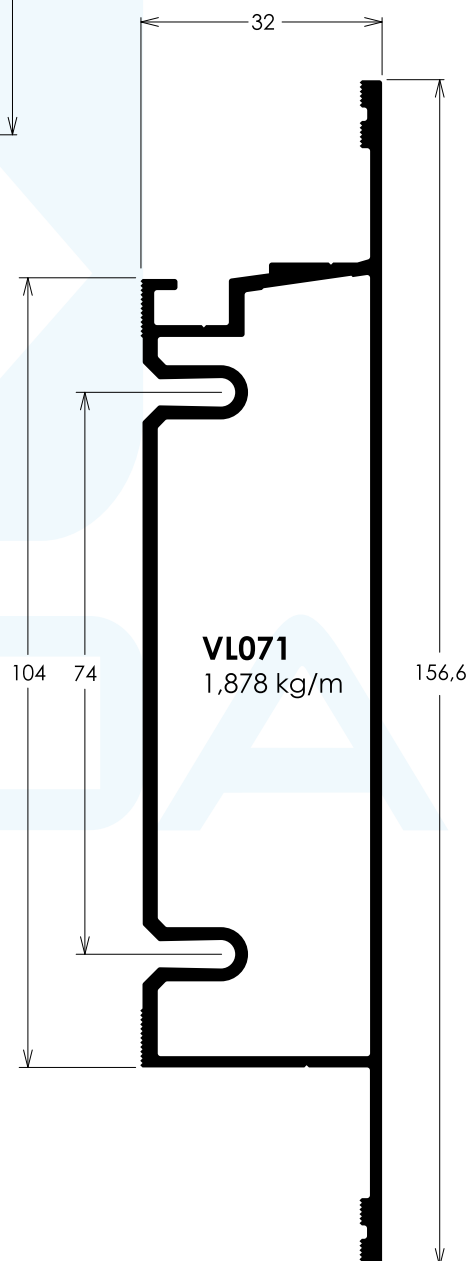
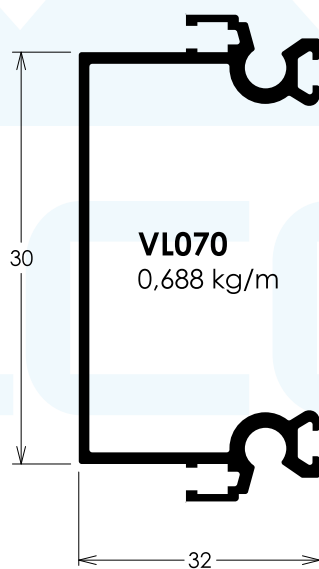
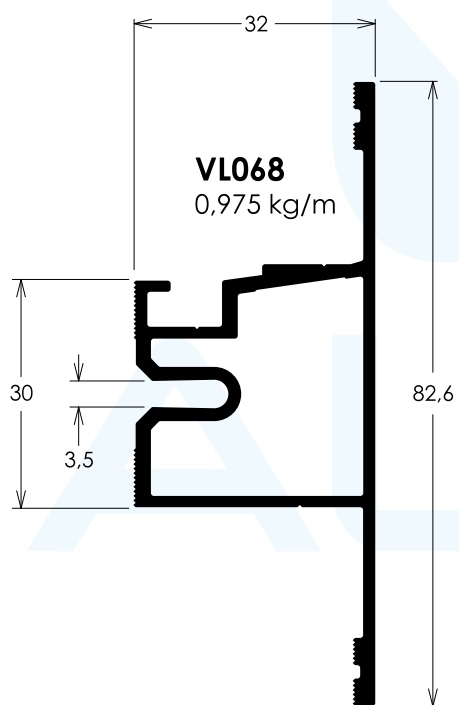
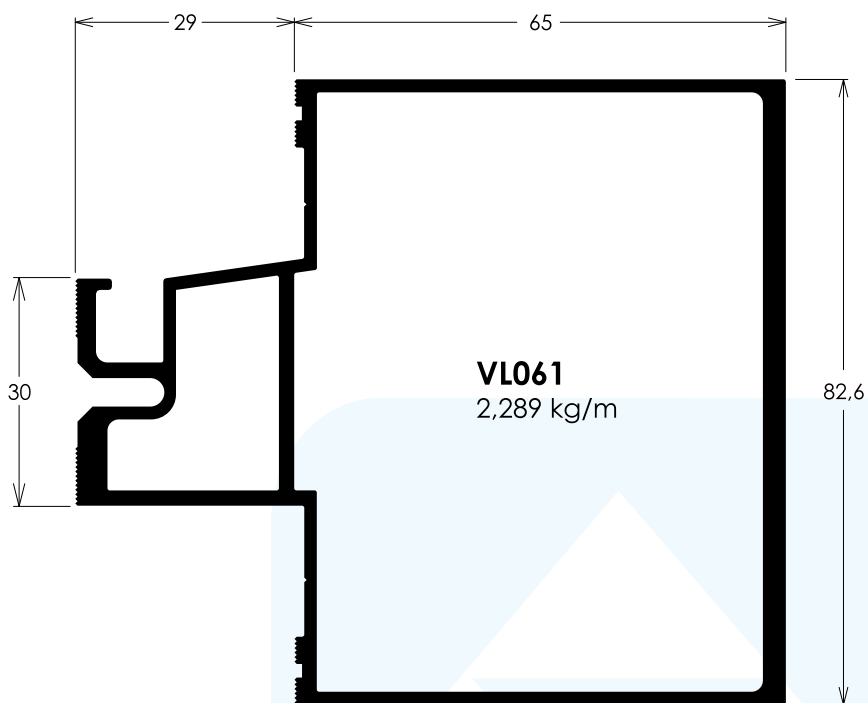



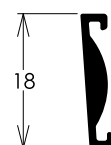
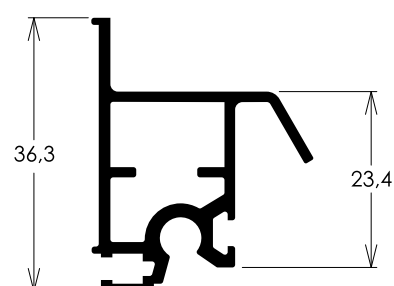
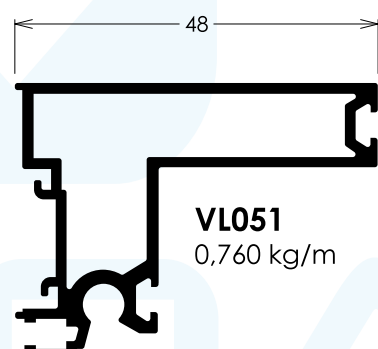
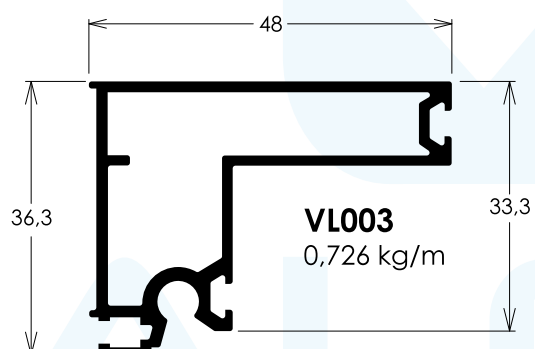
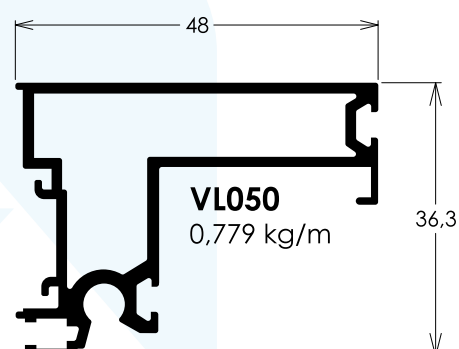
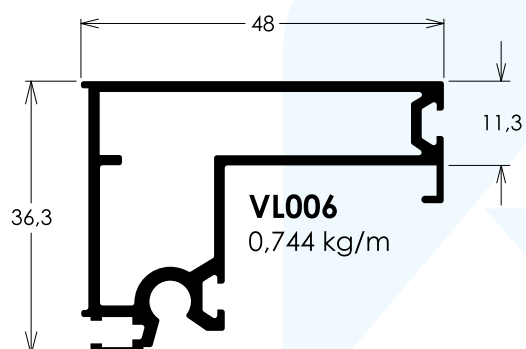
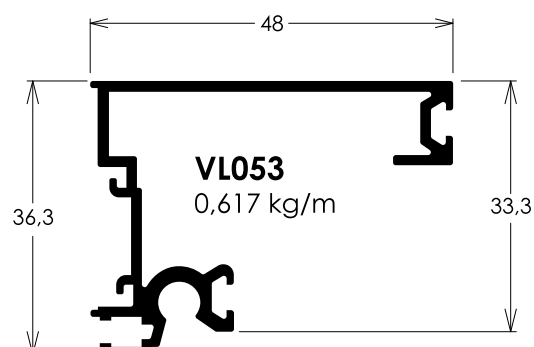
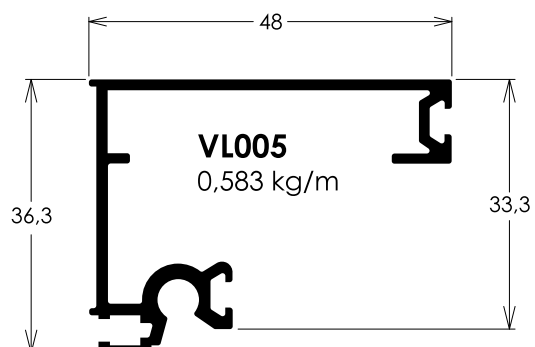

**VL052**  
0,116 kg/m

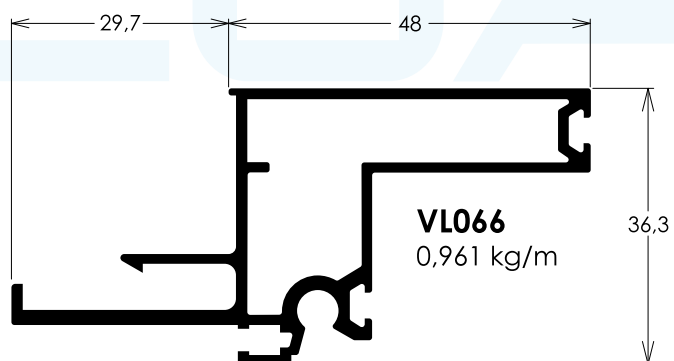
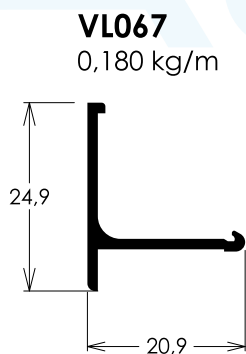
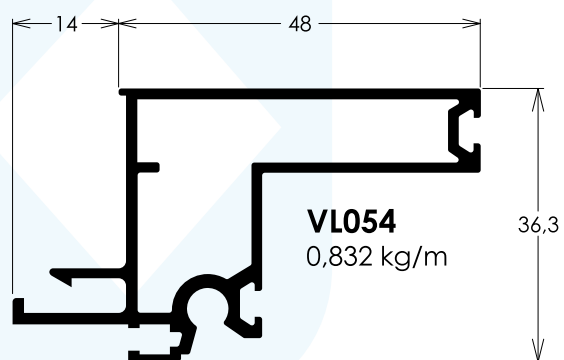
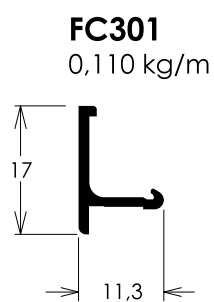
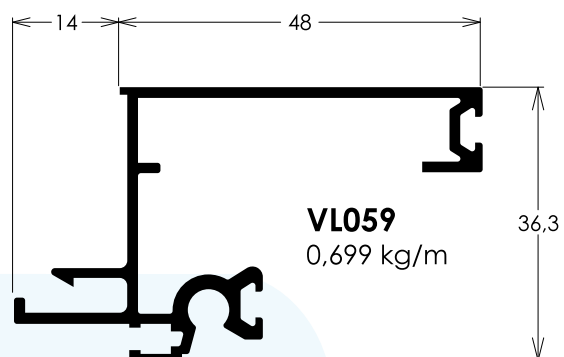
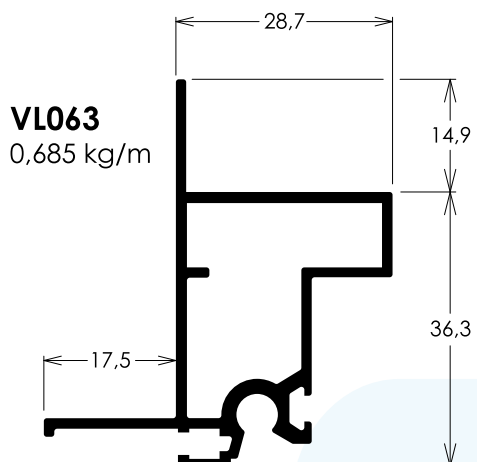

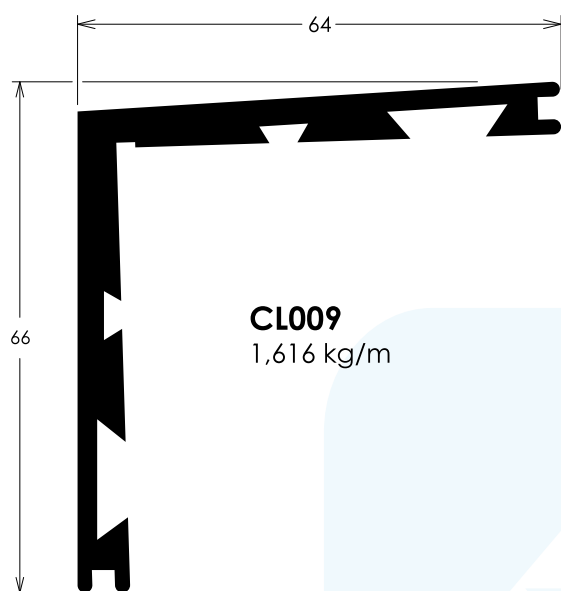

**CL009**  
1,616 kg/m

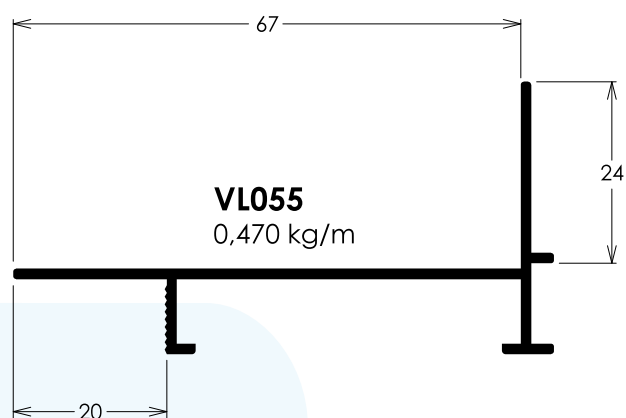

**VL055**  
0,470 kg/m



**CL010**  
0,385 kg/m

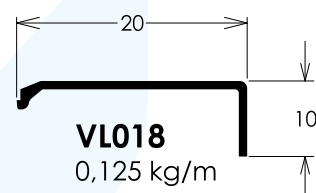

**VL018**  
0,125 kg/m

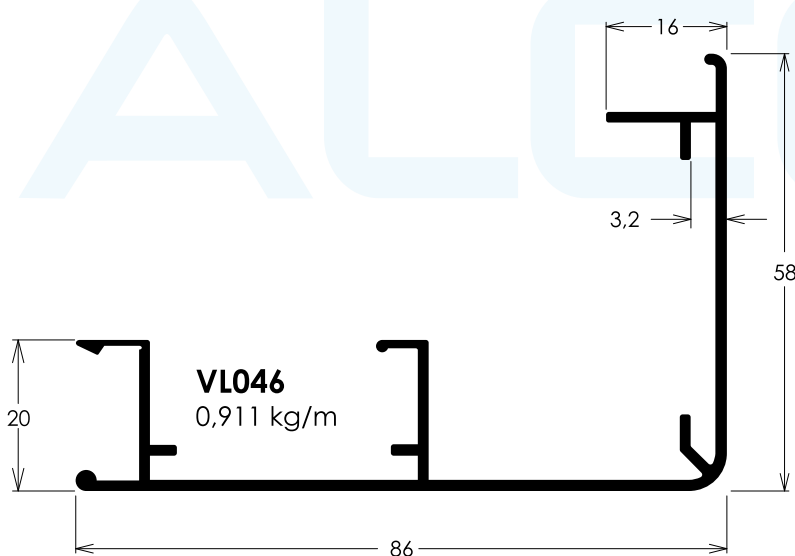

**VL046**  
0,911 kg/m



**VL058**  
0,215 kg/m

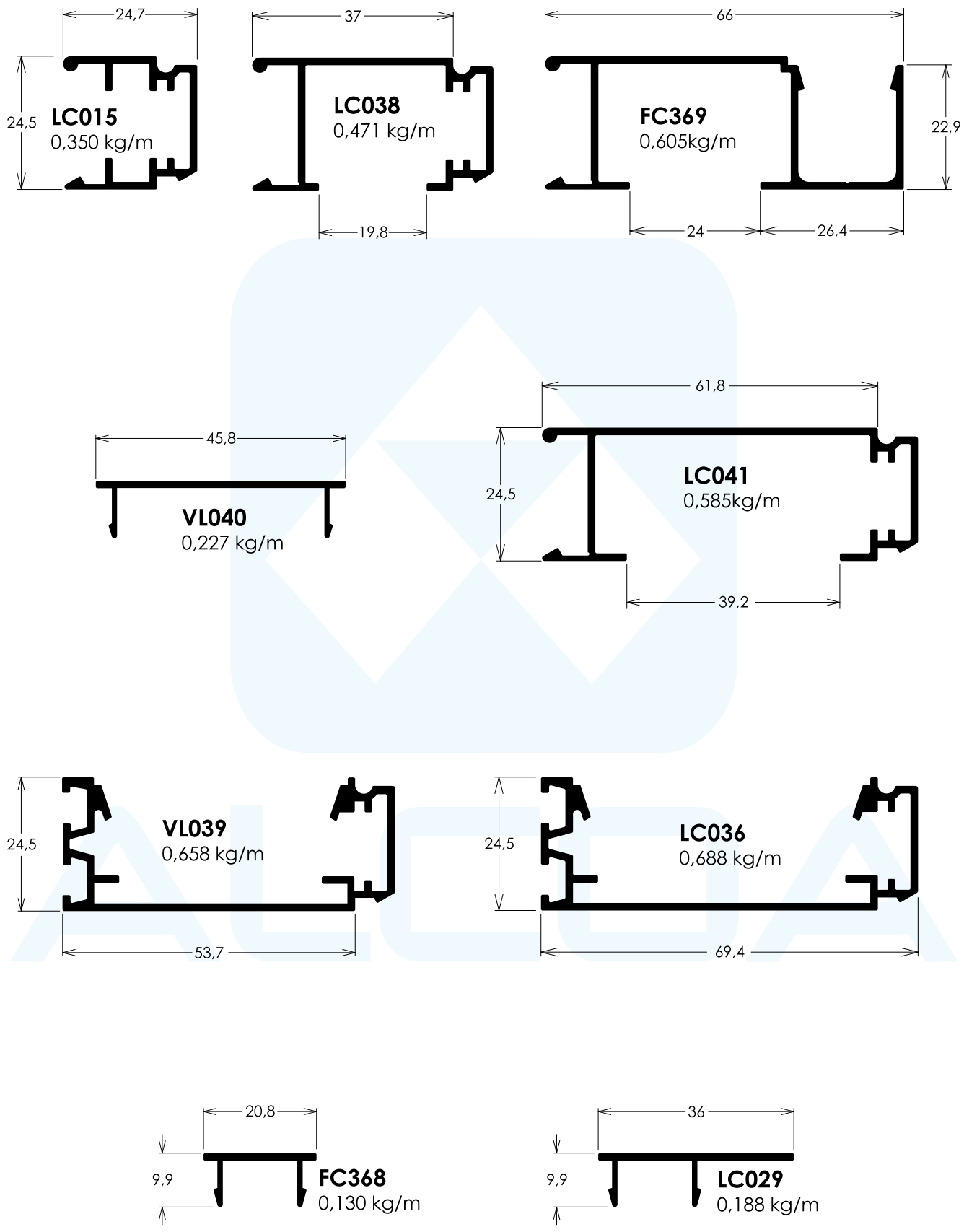

Projetos, perfis, componentes, códigos e sistemas estão sujeitos a alteração sem prévio aviso.

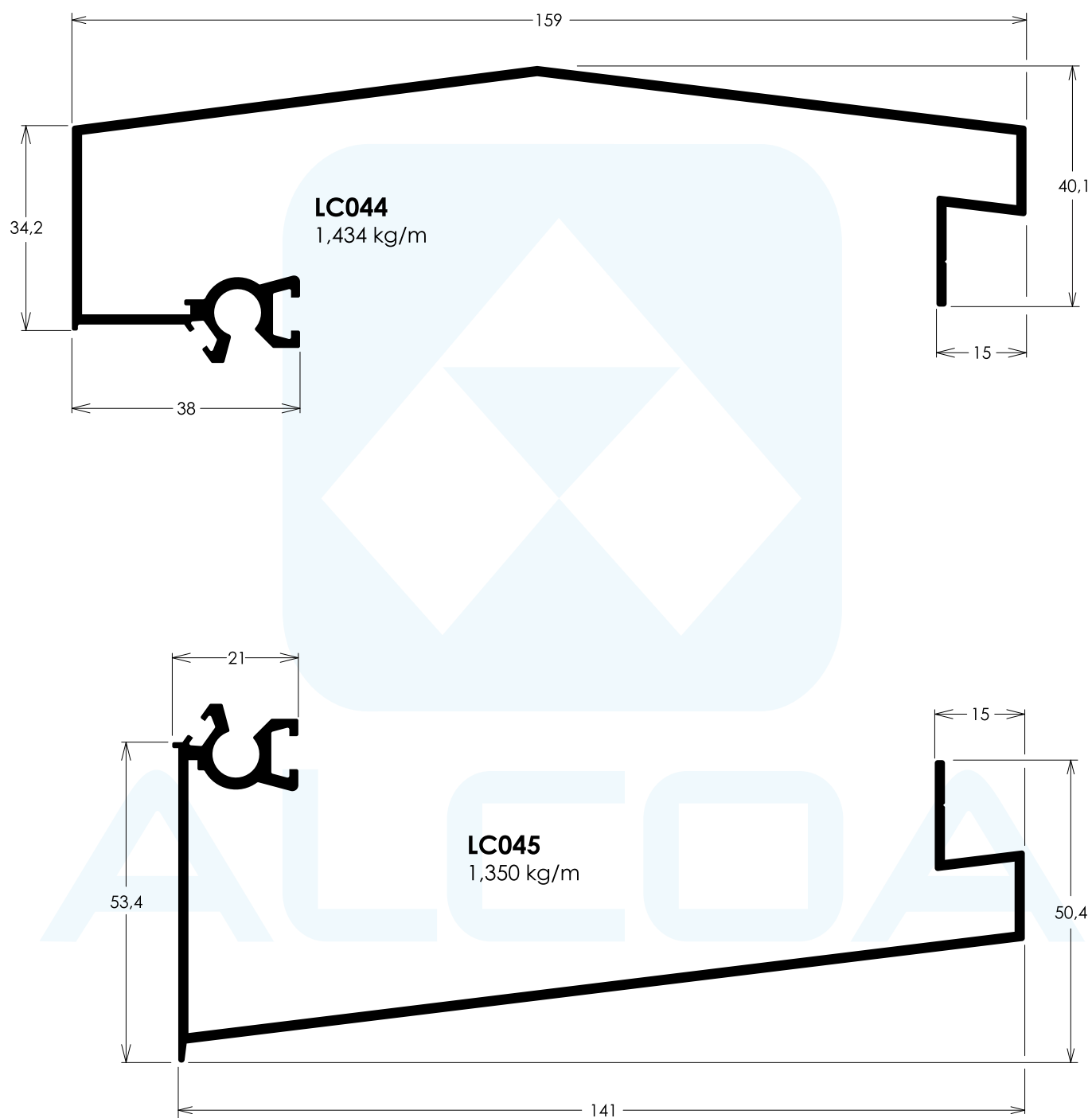



Código	Descrição	Página
ANC800	Ancoragem central para colunas VL001 e VL025	33
ANC801	Ancoragem intermediária para colunas VL001 e VL025	33
ANC802	Ancoragem central para coluna VL024	33
ANC803	Ancoragem intermediária para coluna VL024	33
ANC804	Ancoragem central para coluna VL020	34
ANC805	Ancoragem intermediária para coluna VL020	34
ANC806	Ancoragem inferior para colunas VL024, VL025 e VL001	35
ANC964	Ancoragem - coluna lateral	34
ANC967	Ancoragem 90° para coluna de canto	34
ANC977	Ancoragem telescópica superior	35
ANC979	Ancoragem de fixação para colunas VL024 e VL026	35
ANC980	Ancoragem de fixação para coluna VL027	35
BRA761	Limitador de abertura	39
BRA761	Limitador de abertura	39
BRA762	Braço Maxim-ar	39
BRA763	Braço Maxim-ar	39
BRA764	Braço Maxim-ar	39
BUC755	Bucha para fixação S-8	40
CHU795	Chumbador com porca, arruela e prisioneiro 9,5x80mm	40
CON431E	Fixador de travessas	38
FEC478	Fecho punho - Direito	39
FEC479	Fecho punho - Esquerdo	39
FEC480	Fecho articulado (Direito)	39
FEC481	Fecho articulado (Esquerdo)	39
FEC482	Fecho articulado	39
GUA168	Guarnição	38
GUA246	Guarnição	38
GUA366	Guarnição	38
GUA367	Guarnição	38
GUA368	Guarnição	38
GUA369	Guarnição	38
GUA371	Guarnição adesiva 21 mm x 3 mm - vidro 8 mm	38

Código	Descrição	Página
GUA372	Guarnição adesiva 21 mm x 5 mm - vidro 6 mm	38
GUA375	Guarnição	38
LUV988	Luva para coluna VL001 400mm	36
LUV989	Luva para coluna VL041 400mm	37
LUV990	Luva para coluna VL024	36
LUV991	Luva para coluna VL049 400mm	36
LUV992	Luva para coluna VL042 400mm	37
LUV993	Luva para coluna VL020 400mm	37
PAR060	Parafuso sextavado AA Ø 4,8mmx32mm	40
PAR061	Parafuso sextavado AA Ø 6,3mmx25mm	40
PAR062	Parafuso sextavado WW Ø 1/4"x50mm	40
PAR063	Parafuso sextavado AA Ø 4,8mmx19mm	40
PAR428	Parafuso PP lisa AA Ø 4,8mmx32mm	40
PAR437	Parafuso AA Ø 3,5mmx9,5mm CP	40
PAR690	Parafuso sextavado WW Ø 1/4"x5/8"	40
PAR691	Parafuso AA Ø 4,8mmx13mm CP	40
PAR695	Parafuso AA Ø 4,8mmx19mm CP	40
PAR705	Parafuso AA Ø 4,8mmx16mm CP	40
PAR716	Parafuso sextavado WW Ø 3/8"x5"	40
PAR936	Parafuso AA Ø 4,2mmx16mm CP	40
PAR991	Parafuso AA Ø 4,2mmx13mm CP	40
PAR992	Parafuso AA Ø 4,8mmx50mm CP	40
PRE976	Presilha arremate interno 30mm	38
PRE981	Presilha vertical - Quadros 30mm	38
PRE983R	Presilha horizontal - Quadros 30mm	38
PRE984	Presilha de apoio - Quadros 30mm	38
PRE988	Presilha de fixação - Travessa 38mm	35
PRE989	Presilha de fixação - Travessa 38mm	35
Reddiglaze Super Glue	Adesivo para guarnições	38
VL011	Presilhas	41
VL017	Presilhas	41
VL065	Presilhas	41

ALCOA



## ANC800

Ancoragem Central  
para colunas VL001 e VL025  
Alumínio Natural  
(VL009 / Liga 6351-T6)

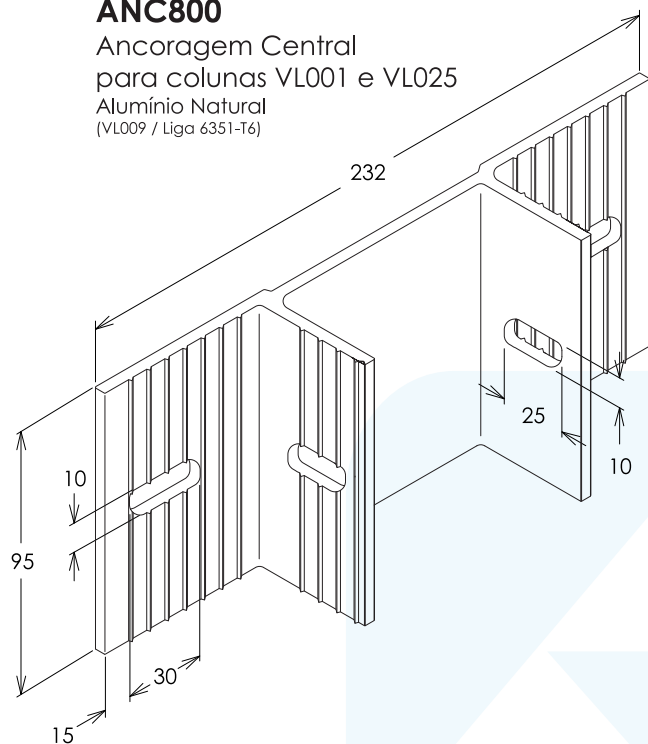

## ANC801

Ancoragem Intermediária  
para colunas VL001 e VL025  
Alumínio Natural  
(VL009 / Liga 6351-T6)

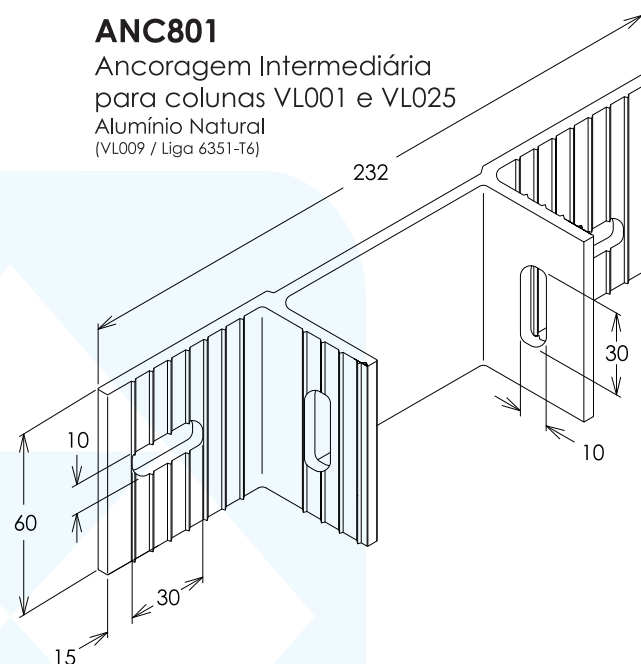

## ANC802

Ancoragem Central  
para coluna VL024  
Alumínio Natural  
(VL048 / Liga 6351-T6)

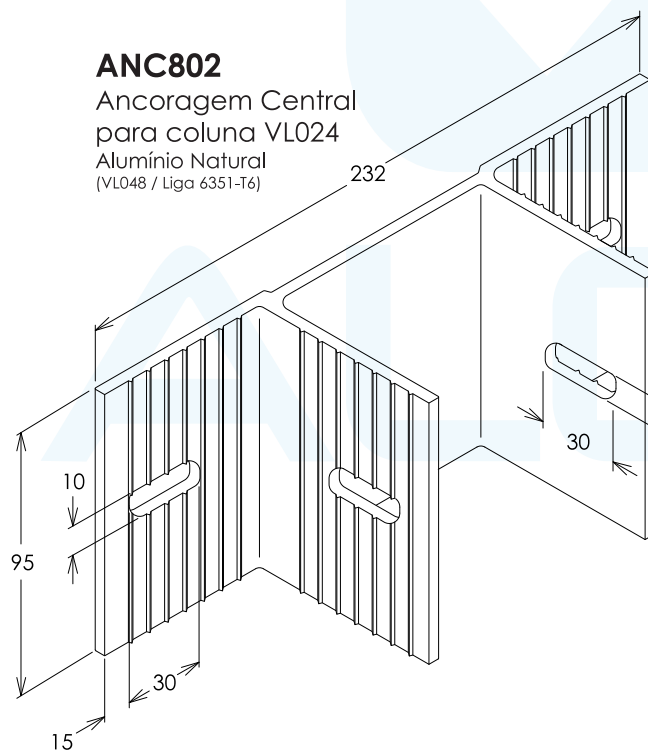

## ANC803

Ancoragem Intermediária  
para coluna VL024  
Alumínio Natural  
(VL048 / Liga 6351-T6)

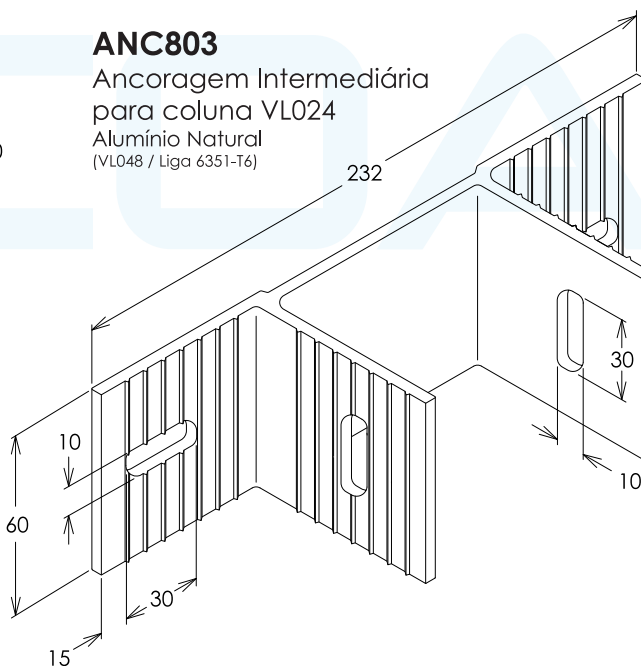



**ANC804**

Ancoragem Central  
para coluna VL020  
Alumínio Natural  
(VL019 / Liga 6351-T6)

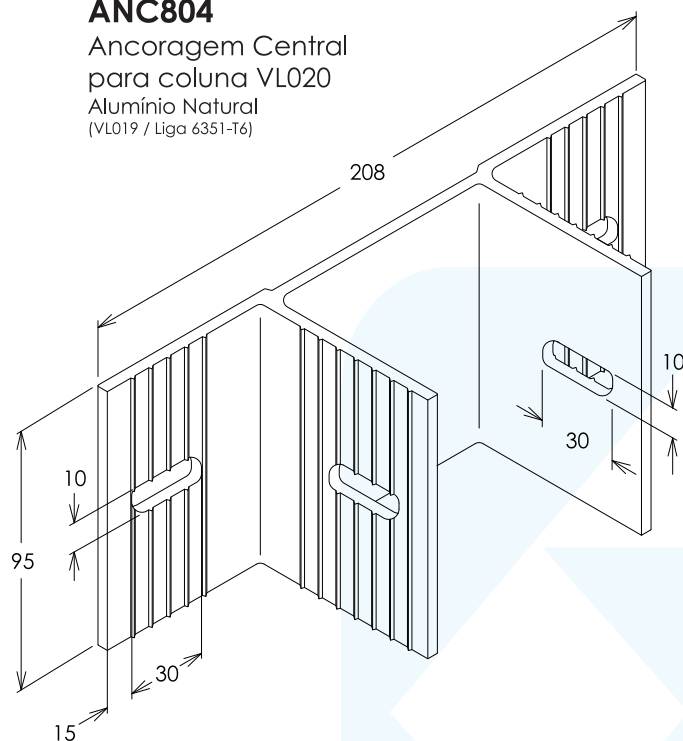

**ANC805**

Ancoragem Intermediária  
para coluna VL020  
Alumínio Natural  
(VL019 / Liga 6351-T6)

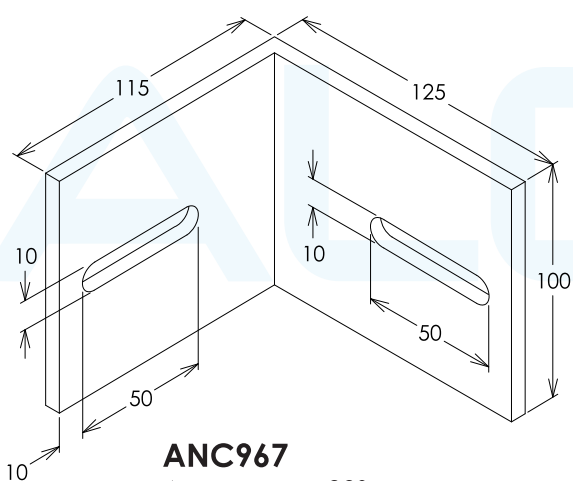
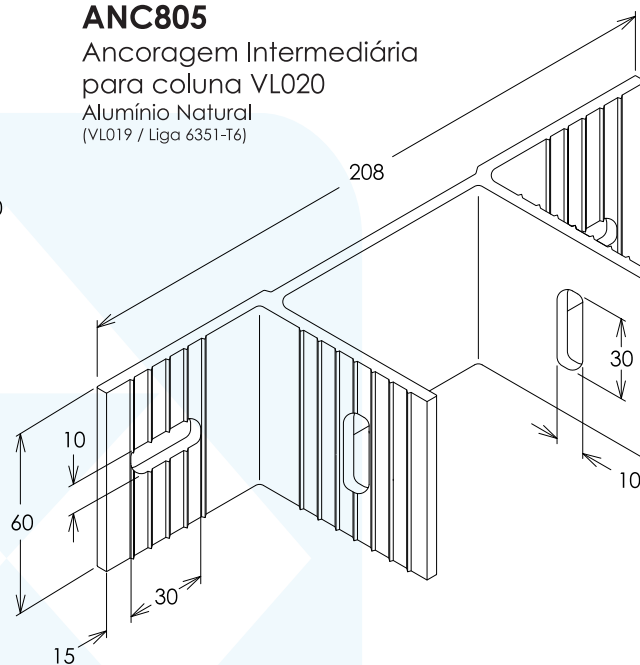

**ANC967**

Ancoragem 90°  
para coluna de canto  
Alumínio Natural  
(CT638)

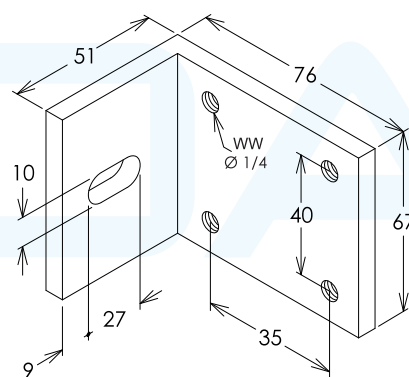

**ANC964**

Ancoragem  
Coluna lateral  
Alumínio Natural  
(CT605)



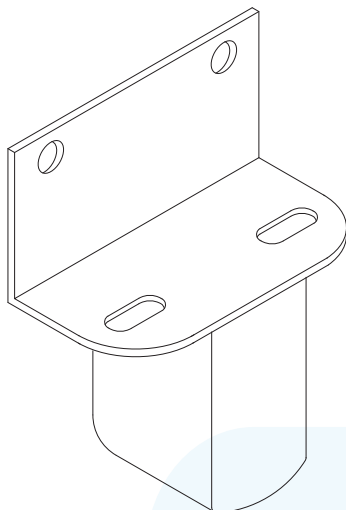

### ANC977

Ancoragem Telescópica Superior  
Alumínio Fundido Natural

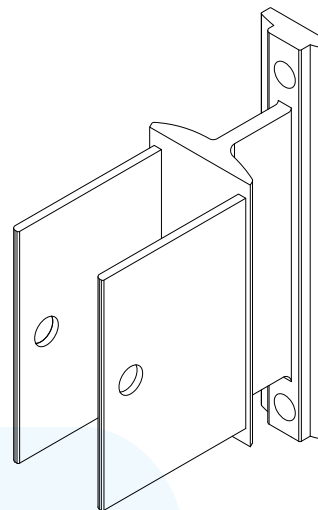

### ANC979

Ancoragem de fixação  
Para colunas VL024 e VL026  
Alumínio Preto  
(LC050)

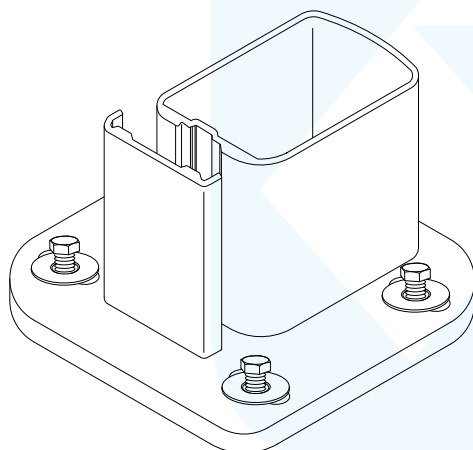

### ANC806

Ancoragem Inferior  
para colunas VL024, VL025 e VL001  
Alumínio Fundido Natural

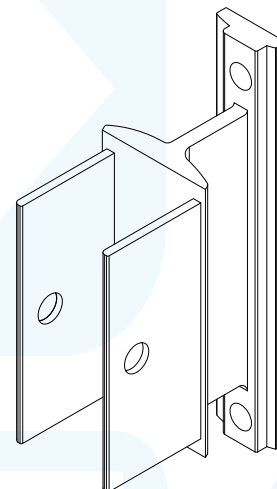

### ANC980

Ancoragem de fixação  
Para coluna VL027  
Alumínio Preto  
(LC050 refilado)

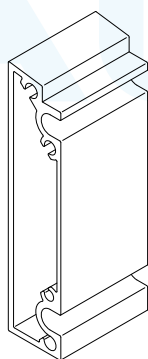

### PRE988

Presilha de fixação  
Travessa  
38 mm  
Alumínio Natural  
(VL072)

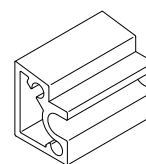

### PRE989

Presilha de fixação  
Travessa  
38 mm  
Alumínio Natural  
(VL069)



**LUV990**  
Luva para coluna VL024  
400 mm  
Alumínio Natural  
(VL043)

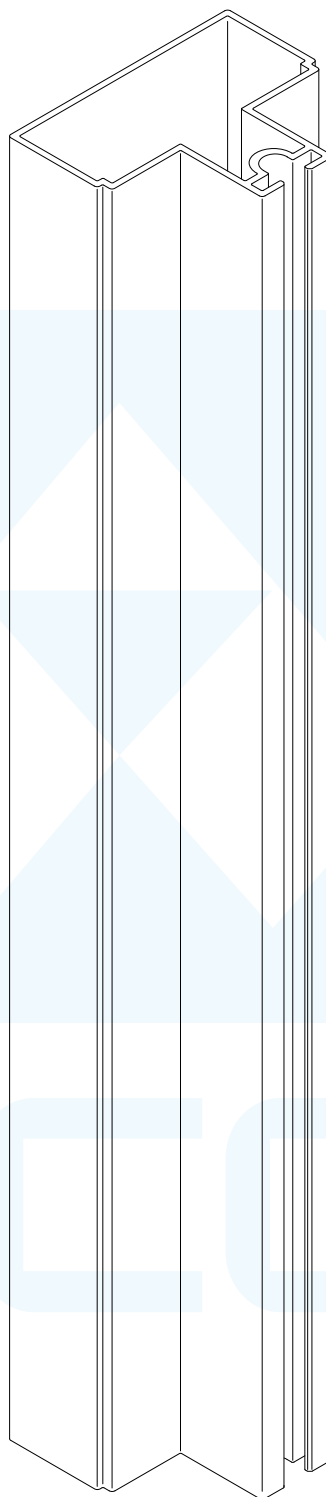

**LUV988**  
Luva para coluna VL001  
400 mm  
Alumínio Natural  
(VL010)

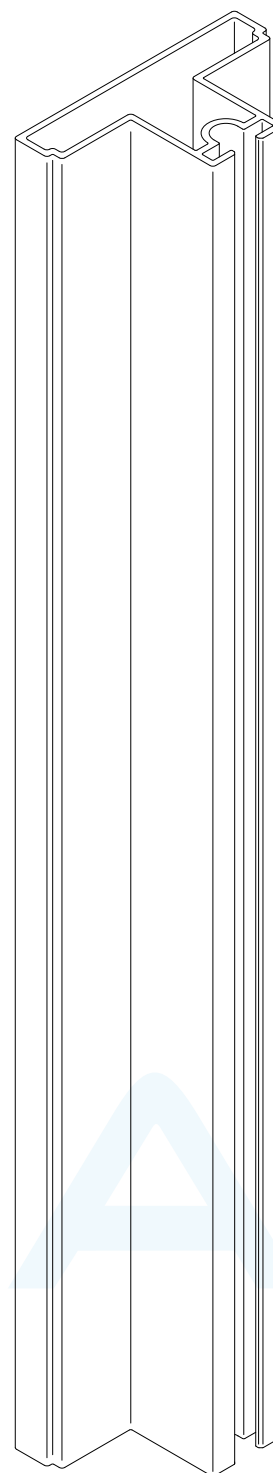

**LUV991**  
Luva para coluna VL025  
400 mm  
Alumínio Natural  
(VL049)



**LUV993**

Luva para coluna VL020  
400 mm  
Alumínio Natural  
(VL022)

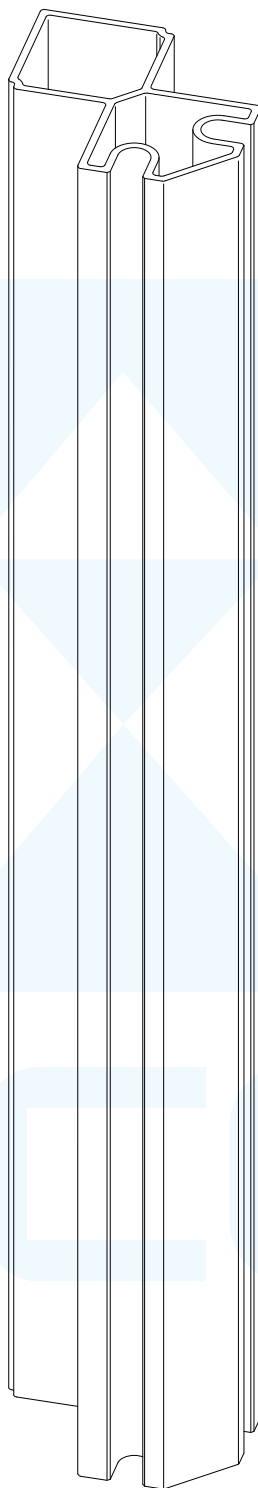

**LUV992**

Luva para coluna VL042  
400 mm  
Alumínio Natural  
(VL045)

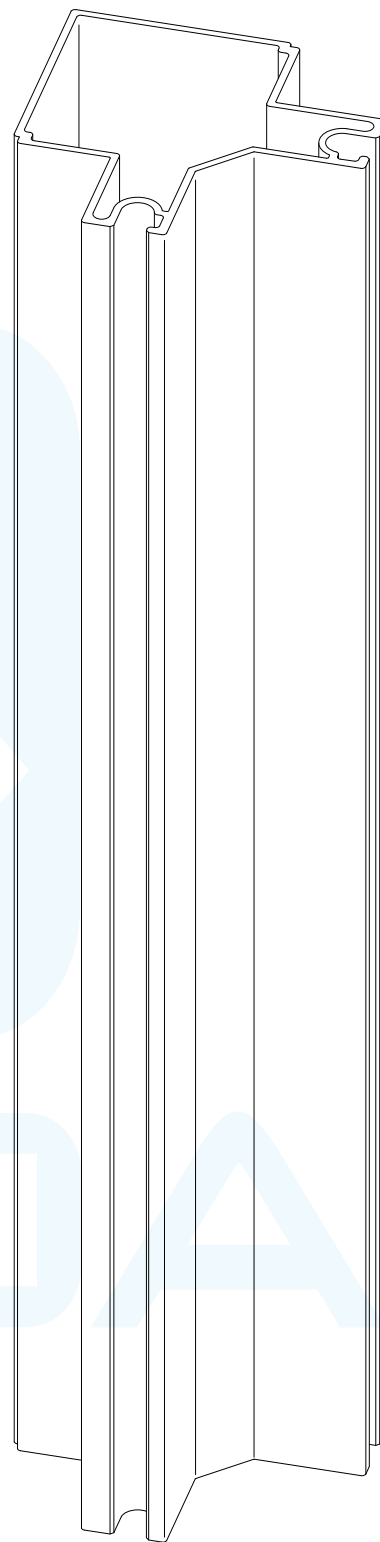

**LUV989**

Luva para coluna VL041  
400 mm  
Alumínio Natural  
(VL044)

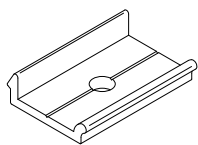

**PRE976**  
Presilha  
Arremate interno  
30 mm  
Alumínio Natural  
(FC400)

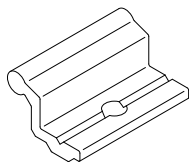

**PRE981**  
Presilha vertical  
Quadros  
30 mm  
Alumínio Preto  
(VL011)

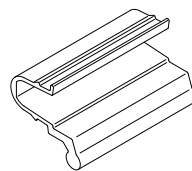

**PRE983R**  
Presilha horizontal  
Quadros  
30 mm  
Alumínio Preto  
(VL065)

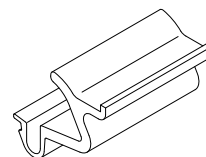

**PRE984**  
Presilha de apoio  
Quadros  
30 mm  
Alumínio Natural  
(VL017)

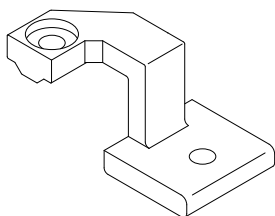

**CON431E**  
Fixador de Travessas  
Alumínio Natural

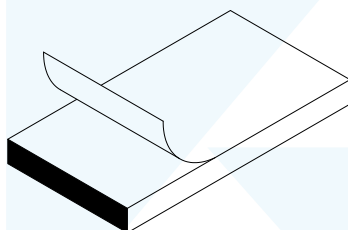

**GUA371**  
Guarnição adesiva  
21mm x 3mm  
vidro 8mm  
PVC Preto - células fechadas

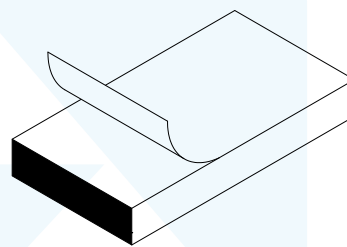

**GUA372**  
Guarnição adesiva  
21mm x 5mm  
vidro 6mm  
PVC Preto - células fechadas



**Reddiglaze**  
Super Glue  
Adesivo  
para Guarnições

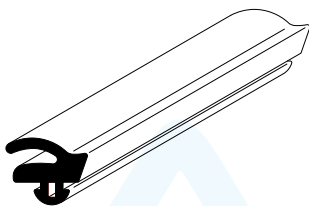

**GUA366**  
Guarnição  
E.P.D.M. Preto

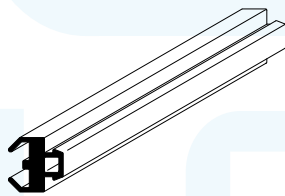

**GUA246**  
Guarnição  
E.P.D.M. Preto

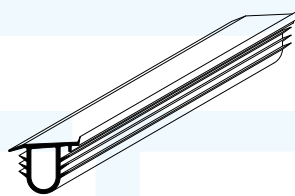

**GUA375**  
Guarnição  
E.P.D.M. Preto

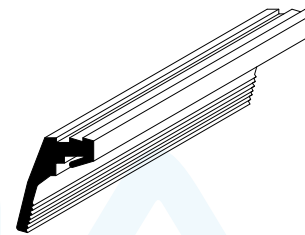

**GUA367**  
Guarnição  
E.P.D.M. Preto

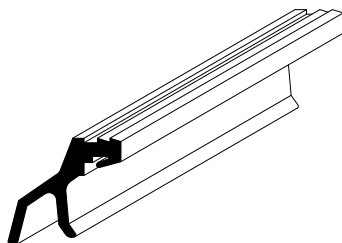

**GUA368**  
Guarnição  
E.P.D.M. Preto

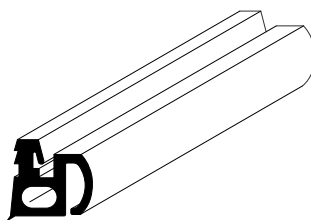

**GUA369**  
Guarnição  
E.P.D.M. Preto

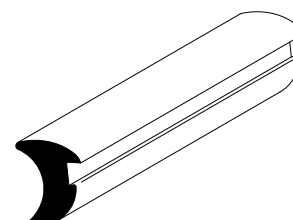

**GUA168**  
Guarnição  
E.P.D.M. Preto

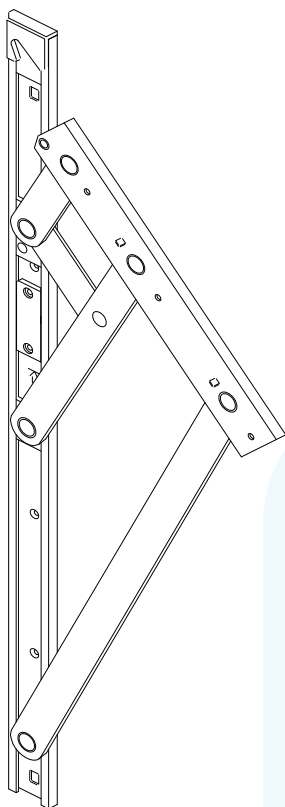

	Dimensão (mm)	Altura da Folha (mm)	Largura da Folha (mm)	Carga Máxima
<b>BRA762</b>	<b>342</b>	Min: 390 Max: 600	Max: 1500	22kg
<b>BRA763</b>	<b>600</b>	Min: 640 Max: 1000	Max: 1500	35kg
<b>BRA764</b>	<b>951</b>	Min: 1000 Max: 1200	Max: 1500	45kg

Braço Maxim ar  
Alumínio Fosco, Preto ou Branco

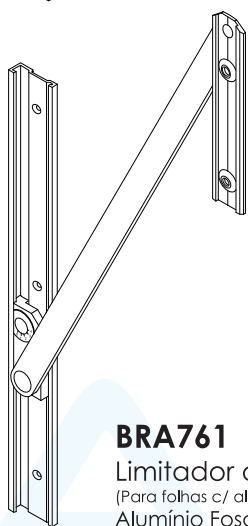

**BRA761**  
Limitador de abertura  
(Para folhas c/ altura acima de 1200mm)  
Alumínio Fosco, Preto ou Branco

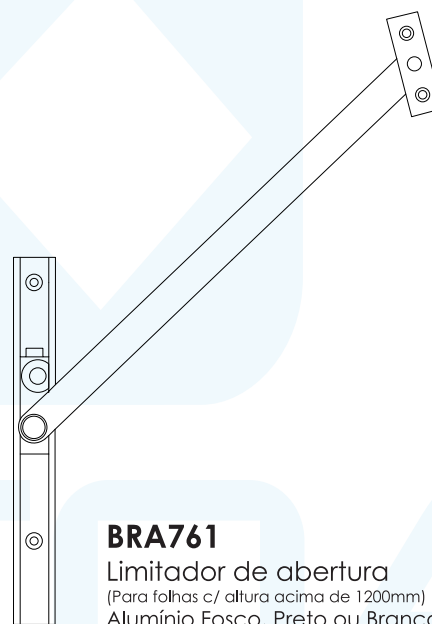

**BRA761**  
Limitador de abertura  
(Para folhas c/ altura acima de 1200mm)  
Alumínio Fosco, Preto ou Branco

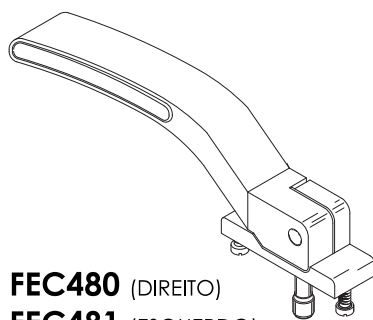

**FEC480** (DIREITO)  
**FEC481** (ESQUERDO)  
Fecho Articulado  
Alumínio Fosco, Preto ou Branco

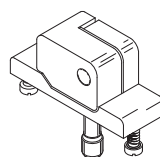

**FEC482**  
Fecho articulado  
Alumínio Preto

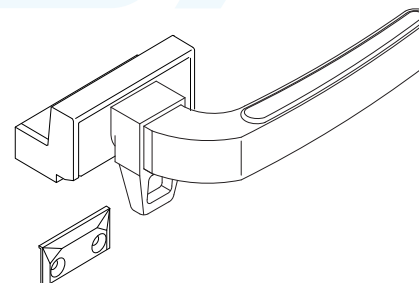

**FEC478** (DIREITO)  
**FEC479** (ESQUERDO)  
Fecho Punho  
Alumínio Fosco, Preto ou Branco



### PAR062

Parafuso sextavado WW Ø 1/4" x 50mm  
2 arruelas e 1 porca  
Aço Inox



### PAR716

Parafuso sextavado WW Ø 3/8" x 5"  
2 arruelas e 1 porca  
Aço Inox

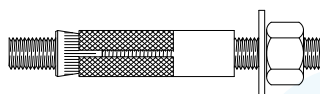

### CHU795

Chumbador com porca, arruela  
e prisioneiro 9,5mm x 80mm  
Aço Inox

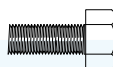

### PAR690

Parafuso sextavado  
WW Ø 1/4" x 5/8"  
Aço Inox

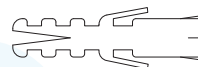

### BUC755

Bucha para fixação S-8  
Nylon

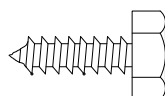

### PAR063

Parafuso sextavado  
AA Ø 4,8mm x 19mm  
Aço Inox

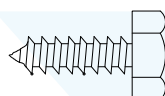

### PAR061

Parafuso sextavado  
AA Ø 6,3mm x 25mm  
Aço Inox

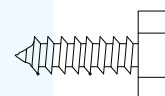

### PAR060

Parafuso sextavado  
AA Ø 4,8mm x 32mm  
Aço Inox



### PAR428

Parafuso PP lisa  
AA Ø 4,8mm x 32mm  
Aço Inox



### PAR437

Parafuso AA  
Ø 3,5mm x 9,5mm CP  
Aço Inox



### PAR991

Parafuso AA  
Ø 4,2mm x 13mm CP  
Aço Inox Preto



### PAR936

Parafuso AA  
Ø 4,2mm x 16mm CP  
Aço Inox



### PAR691

Parafuso AA  
Ø 4,8mm x 13mm CP  
Aço Inox



### PAR705

Parafuso AA  
Ø 4,8mm x 16mm CP  
Aço Inox Preto

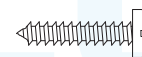

### PAR695

Parafuso AA  
Ø 4,8mm x 19mm CP  
Aço Inox



### PAR992

Parafuso AA  
Ø 4,8mm x 50mm CP  
Aço Inox Preto

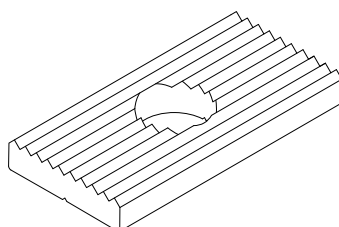

### ARR759

Arruela de ancoragem  
40 mm  
Alumínio Natural  
(FC512)



## Fixação das folhas / Posicionamento das presilhas

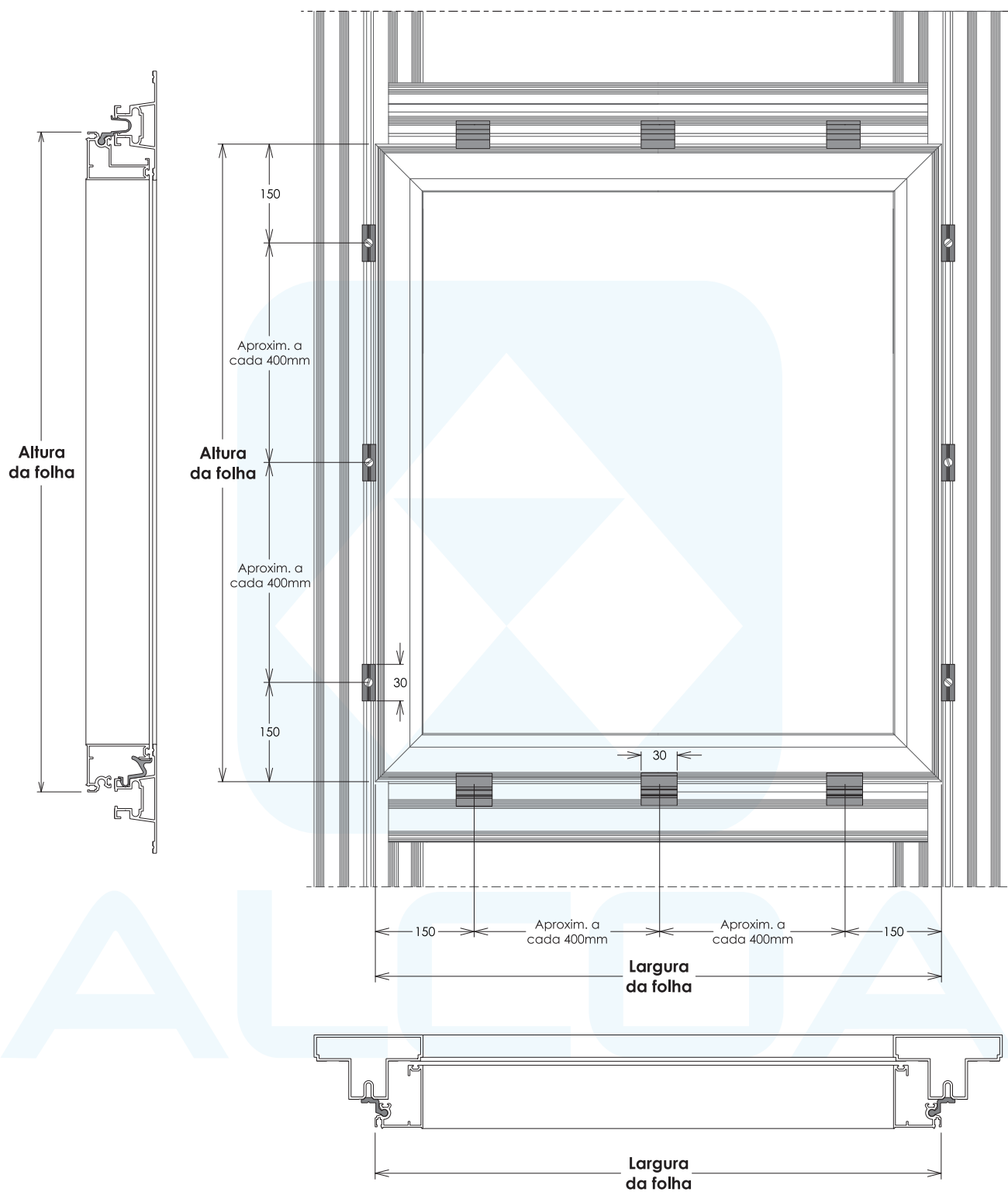

### PRESILHAS

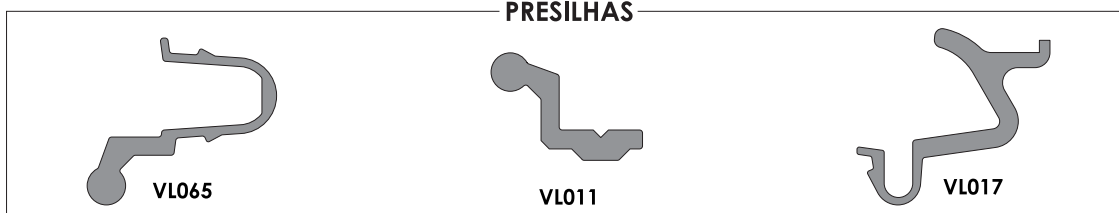





## Arquivos eletrônicos



Os capítulos referentes a



## Usinagens



## Instruções de montagem



## Desenhos de montagem



Encontram-se disponíveis no endereço eletrônico [www.alcoa.com.br/cittadue](http://www.alcoa.com.br/cittadue)

# ALCOA